

REVISIONS					
P	LTR	DESCRIPTION	DATE	DWN	APVD
	G1	REVISED PER ECR-16-011494	22JUN2017	NK	CX

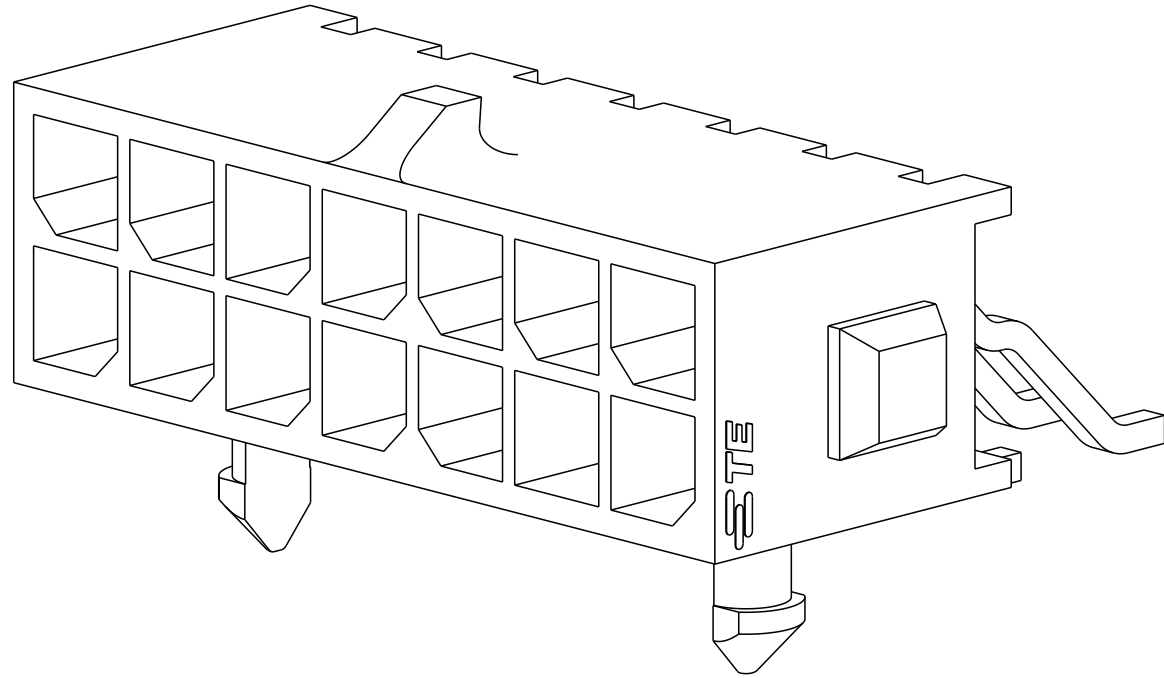

SCALE 6:1

- 1 MATERIAL;
CONTACTS - BRASS.
HOUSING - UL 94V-0 RATED HIGH TEMP NYLON, COLOR; BLACK.
- 2 FINISH;
CONTACTS - 2.54µm MINIMUM TIN-LEAD OVER 1.27µm MINIMUM NICKEL.
- 3 DIMENSION APPLIES TO SOLDERTAIL SURFACES AND STANDOFF SURFACES.
- 4 RECOMMENDED PC BOARD THICKNESS OF 1.57.
- 5 ALL SOLDERTAILS.
- 6 FINISH;
CONTACTS - 2.54µm MINIMUM MATTE TIN OVER 1.27µm MINIMUM NICKEL.

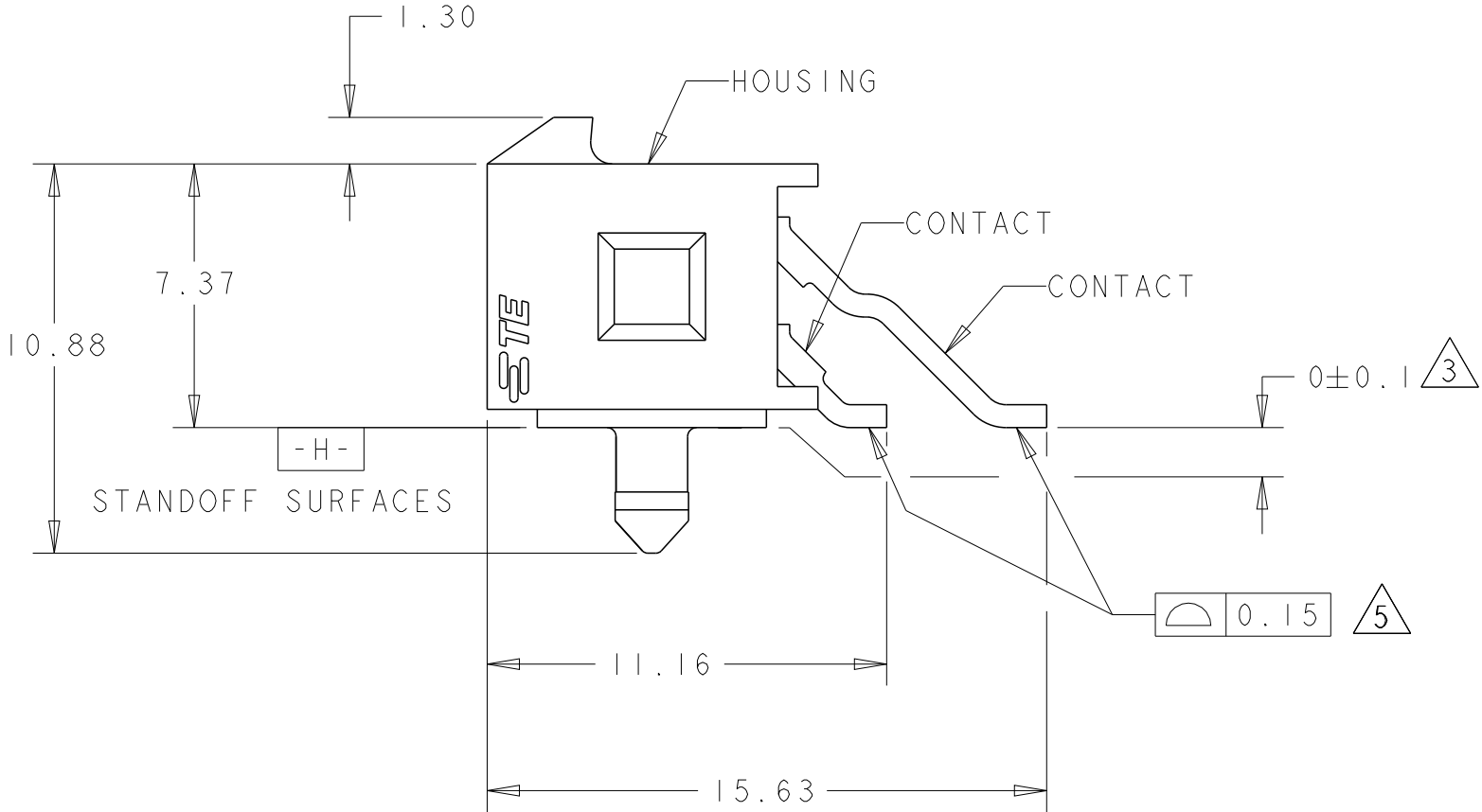
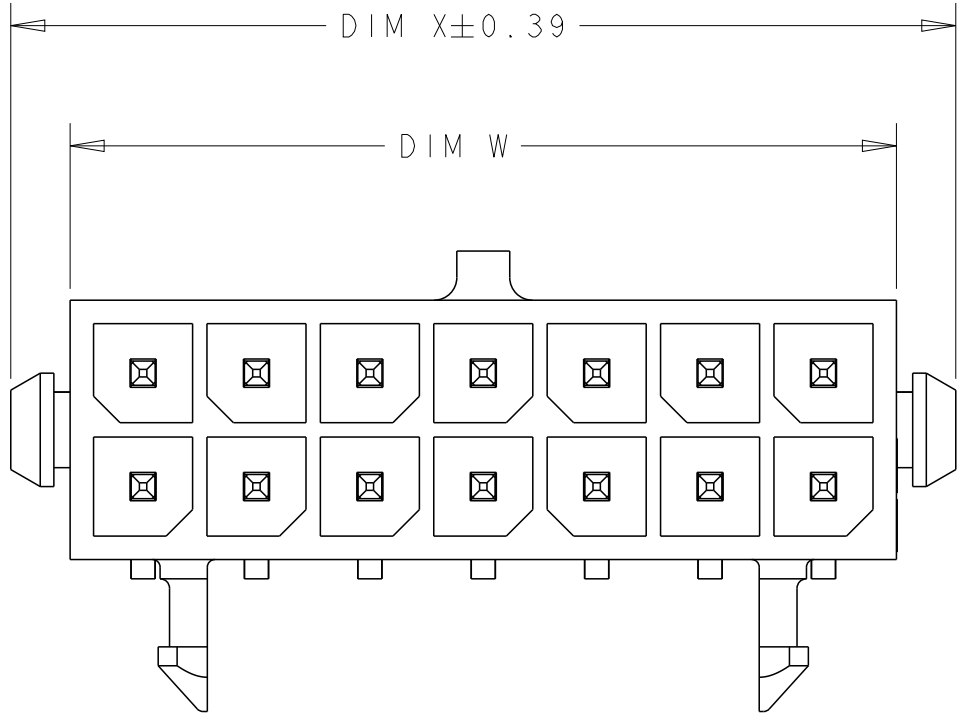
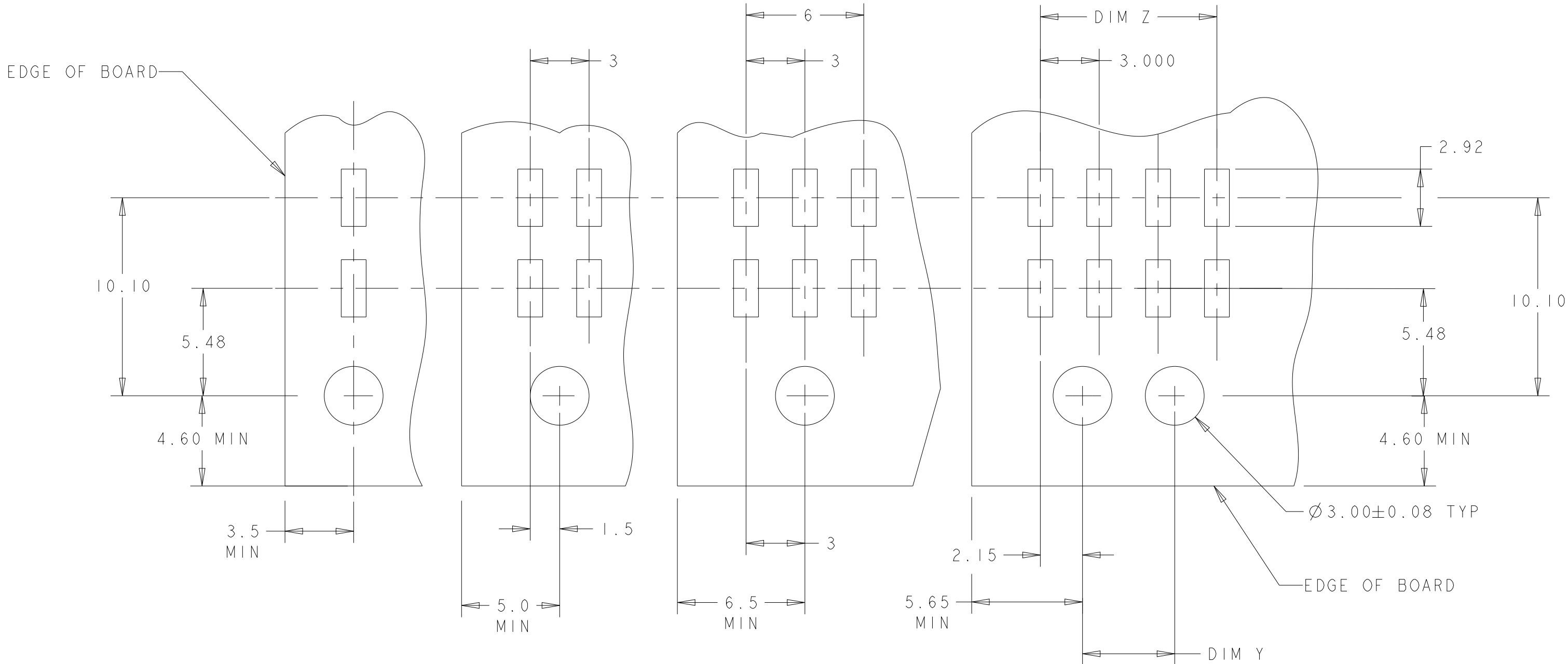
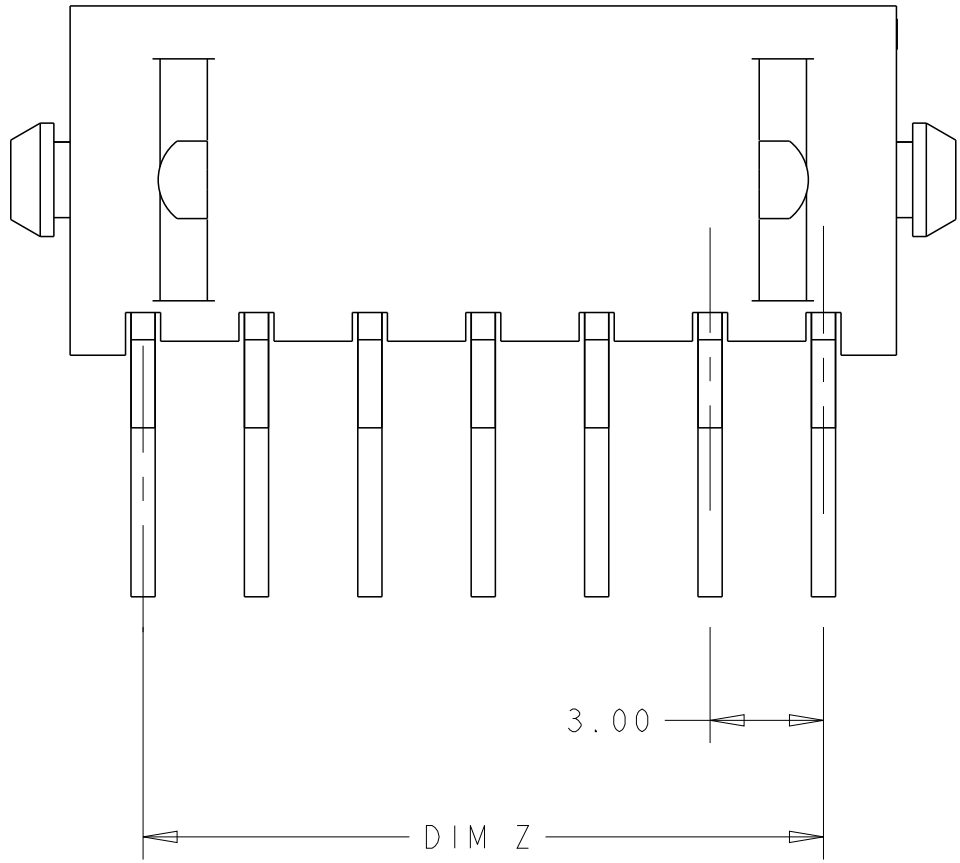

RECOMMENDED PCB LAYOUT (COMPONENT SIDE)

6	36.86	28.70	33.00	40.00	24	5-794621-4
	33.86	25.70	30.00	37.00	22	5-794621-2
	30.86	22.70	27.00	34.00	20	5-794621-0
	27.86	19.70	24.00	31.00	18	4-794621-8
	24.86	16.70	21.00	28.00	16	4-794621-6
	21.86	13.70	18.00	25.00	14	4-794621-4
	18.86	10.70	15.00	22.00	12	4-794621-2
	15.86	7.70	12.00	19.00	10	4-794621-0
	12.86	4.70	9.00	16.00	8	3-794621-8
	9.86	-	6.00	13.00	6	3-794621-6
	6.86	-	3.00	10.00	4	3-794621-4
	3.86	-	-	7.00	2	3-794621-2
	36.86	28.70	33.00	40.00	24	2-794621-4
	33.86	25.70	30.00	37.00	22	2-794621-2

2	30.86	22.70	27.00	34.00	20	2-794621-0
	27.86	19.70	24.00	31.00	18	1-794621-8
	24.86	16.70	21.00	28.00	16	1-794621-6
	21.86	13.70	18.00	25.00	14	1-794621-4
	18.86	10.70	15.00	22.00	12	1-794621-2
	15.86	7.70	12.00	19.00	10	1-794621-0
	12.86	4.70	9.00	16.00	8	794621-8
	9.86	-	6.00	13.00	6	794621-6
	6.86	-	3.00	10.00	4	794621-4
	3.86	-	-	7.00	2	794621-2
	36.86	28.70	33.00	40.00	24	2-794621-4
	33.86	25.70	30.00	37.00	22	2-794621-2
	30.86	22.70	27.00	34.00	20	2-794621-0
	27.86	19.70	24.00	31.00	18	1-794621-8

FINISH	DIM Y	DIM W	DIM Z	DIM X	NO. OF POSN.	PART NUMBER
SUPERSEDED BY 5-794621-4 SUPERSEDED BY 5-794621-2 SUPERSEDED BY 5-794621-0 SUPERSEDED BY 4-794621-8 SUPERSEDED BY 4-794621-6 SUPERSEDED BY 4-794621-4 SUPERSEDED BY 4-794621-2 SUPERSEDED BY 4-794621-0 SUPERSEDED BY 3-794621-8 SUPERSEDED BY 3-794621-6 SUPERSEDED BY 3-794621-4 SUPERSEDED BY 3-794621-2						
S. HOOPER 23-MAR-2005 C. JONES 23-MAR-2005 C. JONES 23-MAR-2005						
TE Connectivity						
ASSEMBLY, SURFACE MOUNT, R/A, TIN HEADER, PLASTIC BOARDLOCK, MICRO MATE-N-LOK(TM)						
A100779C=794621						
CUSTOMER DRAWING						
SCALE 5:1 SHEET 1 OF 1 REV G1						