

APPLICATION DIAGRAM

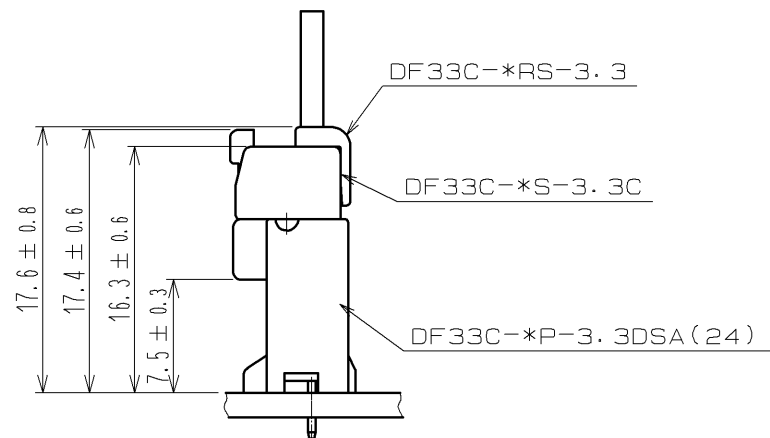

RECOMMENDED PATTERN(5:1)
(RECOMMENDED BOARD THICKNESS $t=1.6mm$)

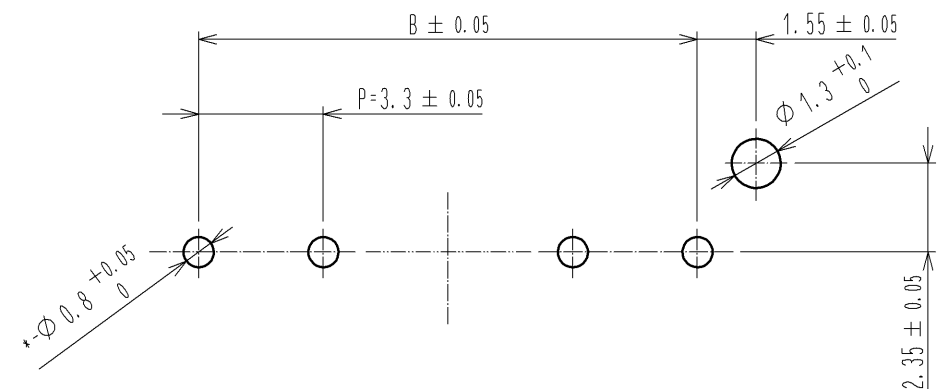

PART No.	CODE No.	THE NUMBER OF CONTACT	A	B	C	D	E
DF33C-2P-3.3DSA(24)	CL676-1131-2-24	2	8.4	—	2.5	3.5	6.8
DF33C-3P-3.3DSA(24)	CL676-1132-5-24	3	11.7	6.6	2.5	3.5	6.8
DF33C-4P-3.3DSA(24)	CL676-1133-8-24	4	15.0	9.9	5.1	6.1	10.15
DF33C-5P-3.3DSA(24)	CL676-1134-0-24	5	18.3	13.2	5.1	6.1	10.15
DF33C-6P-3.3DSA(24)	CL676-1135-3-24	6	21.6	16.5	5.1	6.1	10.15

- NOTES 1 :IMMERSION DEPTH INTO POTTING SOLUTION:6.5mm
2 :FORCEFULLY UNMATING THE CONNECTORS WILL RISK DAMAGING THEM; THEREFORE,WHEN IT IS DIFFICULT TO UNMATE A CONNECTOR,FIRST GENTLY PRESS DOWN ON IT,THEN RELEASE THE LOCK TO ALLOW REMOVAL.

1		POLYAMIDE	BEIGE, UL94V-0	3	HIPS	TRAY
2		BRASS		2	BRASS	SURFACE:TIN PLATED $1\mu m$ min UNDER PLATING:NICKEL PLATED $0.5\mu m$ min
NO.	MATERIAL	FINISH , REMARKS		NO.	MATERIAL	FINISH , REMARKS
UNITS mm		SCALE 2 : 1	COUNT 	DESCRIPTION OF REVISIONS		DESIGNED
		APPROVED :KI. AKIYAMA	13.12.17	DRAWING NO.		EDC3-354785-01
HIROSE ELECTRIC CO., LTD.		CHECKED :HK. UMEHARA	13.12.17	PART NO.		DF33C-*P-3.3DSA(24)
		DESIGNED :HT. SATO	13.12.17	CODE NO.		CL676-
		DRAWN :MI. SAKIMURA	13.12.17			

