

J
I
H
G
F
E
D
C
B
A

13 12 11 10 9 8 7 6 5 4 3 2 1

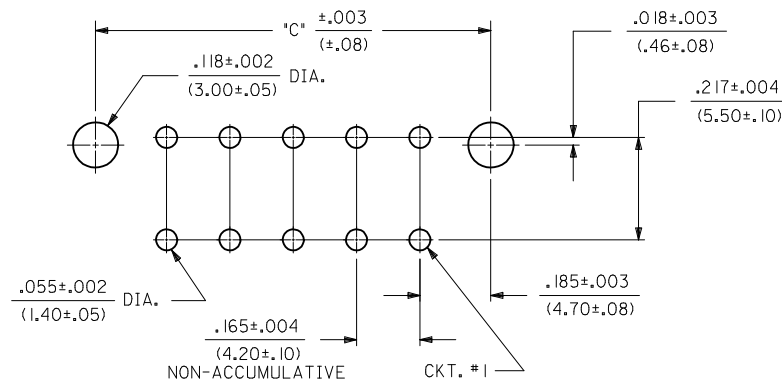
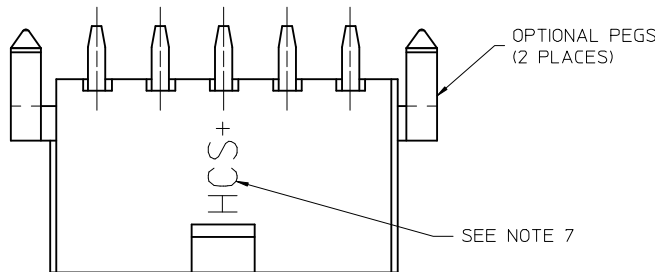

RECOMMENDED HOLE LAYOUT FOR
.070/(1.78) MAX. THICK P. C. BOARD

CIRCUIT SIZE	DIM. "A"	DIM. "B"	DIM. "C"
2	—	.21 (5.4)	.370 (9.40)
4	.17 (4.2)	.38 (9.6)	.535 (13.60)
6	.33 (8.4)	.54 (13.8)	.701 (17.80)
8	.50 (12.6)	.71 (18.0)	.866 (22.00)
10	.66 (16.8)	.87 (22.2)	1.031 (26.20)
12	.83 (21.0)	1.04 (26.4)	1.197 (30.40)
14	.99 (25.2)	1.20 (30.6)	1.362 (34.60)
16	1.16 (29.4)	1.37 (34.8)	1.528 (38.80)
18	1.32 (33.6)	1.54 (39.0)	1.693 (43.00)
20	1.49 (37.8)	1.70 (43.2)	1.858 (47.20)
22	1.65 (42.0)	1.87 (47.4)	2.024 (51.40)
24	1.82 (46.2)	2.03 (51.6)	2.189 (55.60)

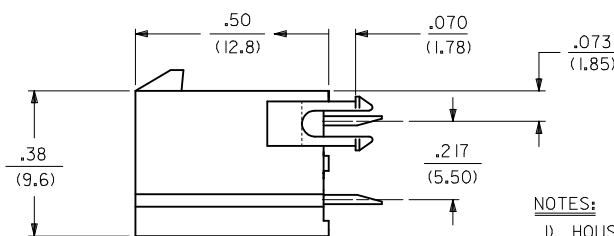
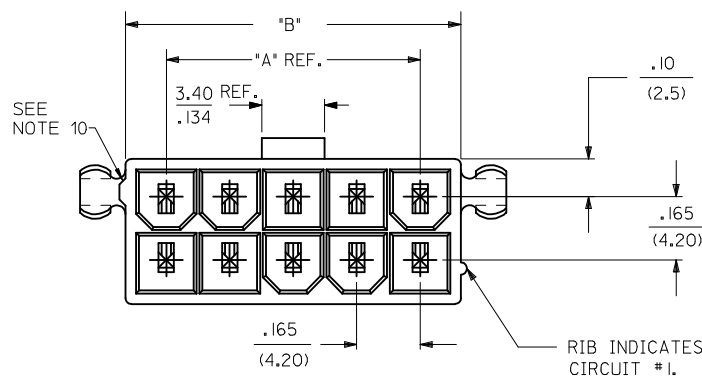

NOTES:

- HOUSING MATERIAL:
V-2 = NYLON 6/6, UNFILLED U.L. 94V-2, COLOR: NATURAL.
V-0 = NYLON 6/6, UNFILLED U.L. 94V-0, COLOR: NATURAL.
GW V-0 = NYLON UL94V-0, COLOR: BLACK
IEC 60335-1 4TH EDITION GLOW WIRE CAPABLE
GW V-2 = NYLON UL94V-2, COLOR: BLACK
IEC 60335-1 4TH EDITION GLOW WIRE CAPABLE
TERMINAL MATERIAL: COPPER ALLOY.
- TERMINAL PLATING:
TIN = .000100/(.00254) MIN. MATTE TIN OVER .000050/(.00127)
MIN. NICKEL OVERALL
GOLD = .000030/(.00080) MIN. SELECT GOLD, .000100/(.00254) MIN.
MATTE TIN OVER .000050/(.00127) MIN. NICKEL OVERALL
- PRODUCT SPECIFICATION: PS-45750-001
- PACKAGING SPECIFICATION: PK-5566-001.
- PART MATES WITH MINI-FIT JR. RECEPTACLE NO. 5557.
- PART ARE NOT TO BE MATED OR UN-MATED WHILE CIRCUITS ARE LIVE.
- PARTS TO HAVE "HCS+" MARKING
- PART CONFORMS TO CLASS B OF COSMETIC SPECIFICATION PS-45499-002
WITH THE EXCEPTION OF DISCOLORATION, FLASH, AND SINK MEET CLASS
"C" REQUIREMENTS.
- PART IS NOT DESIGNED FOR CURRENT SHARING.
- ANTI-SHINGLING RIB MAY OR MAY NOT APPEAR ON
HOUSINGS.

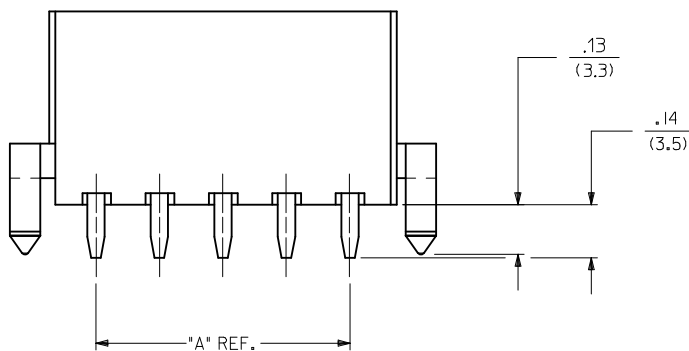

ADD 46015 P/N'S EC NO: UCP2014-2379 DRWN:NGUYEN 2013/12/03 CHKD:JBELL 2013/12/03 APPR:FSMITH 2013/12/19	DESCRIPTION REV	QUALITY SYMBOLS <div>F=0</div> <div>F=0</div> <div>F=0</div>	GENERAL TOLERANCES (UNLESS SPECIFIED)		DIMENSION STYLE IN/MM		SCALE 4:1	DESIGN UNITS METRIC	THIRD ANGLE PROJECTION			
				mm	INCH	DRAWN BY TGREGORI	DATE 2006/04/27	TITLE VERTICAL HEADER ASSEMBLY DUAL ROW MINI-FIT PLUS HCS SERIES molex				
			4 PLACES	± ---	± ---	CHECKED BY JCOMERC I	DATE					
			3 PLACES	± ---	± .010	APPROVED BY	DATE					
			2 PLACES	± 0.25	± .020	FSMITH	2010/04/09	MATERIAL NO.		DOCUMENT NO.		SHEET NO.
C3	REV		ANGULAR ±1/2°		SEE TABLE		SD-46015-001		1 OF 2			
			DRAFT WHERE APPLICABLE MUST REMAIN WITHIN DIMENSIONS		SIZE		THIS DRAWING CONTAINS INFORMATION THAT IS PROPRIETARY TO MOLEX INCORPORATED AND SHOULD NOT BE USED WITHOUT WRITTEN PERMISSION					

13		12		11		10		9		8		7		6		5		4		3		2		1				
ITEM NO.		CKT SIZE	HOUSING MATERIAL	PEGS	PLATING													ITEM NO.	CKT SIZE	HOUSING MATERIAL	PEGS	PLATING						
J	46015-0202	2	V-0	NO	TIN													46015-1402	14	V-0	NO	TIN			J			
	46015-0203			YES														46015-1403			YES							
	46015-0206		V-2	NO														46015-1406		NO	GOLD		I					
	46015-0207			YES														46015-1407		YES								
I	46015-0211		GW V-0	YES													46015-1409	YES		GOLD		I						
	46015-0213		GW V-2	YES													46015-1412	NO										
	46015-0209		V-0	YES													46015-1602	NO			TIN		I					
	46015-0210		GW V-0	YES													46015-1603	YES										
H	46015-0212		V-0	NO													46015-1606	NO		GOLD		H						
	46015-0214		GW V-2	YES													46015-1607	YES										
	46015-0402		V-0	NO													46015-1609	YES			TIN		H					
	46015-0403			YES													46015-1612	NO										
H	46015-0406	4	V-2	NO	TIN													46015-1802	18	V-0		NO		GOLD	G			
	46015-0407			YES														46015-1803				YES						
	46015-0411		GW V-0	YES														46015-1806		NO	TIN	G						
	46015-0413		GW V-2	YES														46015-1807		YES								
G	46015-0409		V-0	YES													46015-1809	YES		GOLD			G					
	46015-0410		GW V-0	YES													46015-1812	NO										
	46015-0412		V-0	NO													46015-2002	NO			TIN	F						
	46015-0414		GW V-2	YES													46015-2003	YES										
F	46015-0602		6	V-0	NO	TIN														46015-2006			V-2	NO	GOLD	F		
	46015-0603				YES															46015-2007				YES				
	46015-0606			V-2	NO															46015-2009	YES	TIN	F					
	46015-0607			YES													46015-2012	NO										
F	46015-0611	GW V-0		YES													46015-2202	22	V-0	NO	TIN			E				
	46015-0613	GW V-2		YES													46015-2203			YES								
	46015-0609	V-0		YES													46015-2206	NO	GOLD	E								
	46015-0610	GW V-0		YES													46015-2207	YES										
E	46015-0612	V-0		NO													46015-2209	YES			TIN	E						
	46015-0614	GW V-2		YES													46015-2212	NO										
	46015-0802	8		V-0	NO	TIN													46015-2402	24			V-0	NO	GOLD	D		
	46015-0803				YES														46015-2403					YES				
46015-0806	V-2		NO													46015-2406	NO	TIN	D									
46015-0807			YES													46015-2407	YES											
D	46015-0811		GW V-0	YES													46015-2409			YES	GOLD	D						
	46015-0813		GW V-2	YES													46015-2412			NO								
	46015-0809		V-0	YES													46015-2402	V-0	NO	TIN			C					
	46015-0810		GW V-0	YES													46015-2403		YES									
C	46015-0812		V-0	NO													46015-2406	V-2	NO		GOLD	C						
	46015-0814		GW V-2	YES													46015-2407		YES									
	46015-1002		10	V-0	NO	TIN													46015-2409	V-0			YES	GOLD	B			
	46015-1003				YES														46015-2412				NO					
46015-1006	V-2	NO														46015-2402	24	V-0	NO	TIN	B							
46015-1007		YES														46015-2403			YES									
B	46015-1011	GW V-0		YES													46015-2406	V-2	NO			GOLD	B					
	46015-1013	GW V-2		YES													46015-2407		YES									
	46015-1009	V-0		YES													46015-2409	V-0	YES	GOLD	A							
	46015-1010	GW V-0		YES													46015-2412		NO									
A	46015-1012	V-0		NO													46015-2402	24	V-0			NO	TIN	A				
	46015-1014	GW V-2		YES													46015-2403					YES						
	46015-1202	12		V-0	NO	TIN													46015-2406	V-2	NO	GOLD			A			
	46015-1203				YES														46015-2407		YES							
46015-1206	V-2		NO													46015-2409	V-0	YES	GOLD	A								
46015-1207			YES													46015-2412		NO										
A	46015-1211		GW V-0	YES													46015-2402	24			V-0	NO	TIN	A				
	46015-1213		GW V-2	YES													46015-2403					YES						
	46015-1209		V-0	YES													46015-2406	V-2	NO	GOLD	A							
	46015-1210		GW V-0	YES													46015-2407		YES									
A	46015-1212		V-0	NO													46015-2409	V-0	YES			GOLD	A					
	46015-1214		GW V-2	YES													46015-2412		NO									
1b_frame_C_P_AM_T Rev. G 2012/01/11			12		11		10		9		8		7		6		5		4		3			2		1		