

REVISIONS					
P	LTR	DESCRIPTION	DATE	DWN	APVD
	AD11	62420-9 REELING DIRECTION UPDATED	10JAN2018	SV	PKS

D

C

B

A

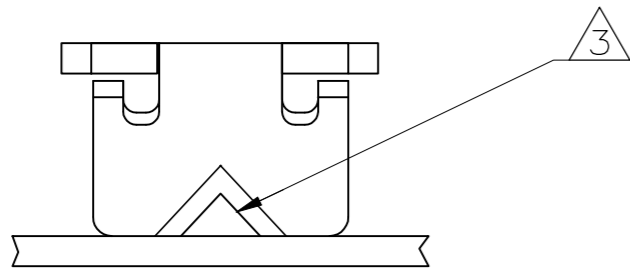

IDENTIFICATION NUMBER 15
FOR MAGNET WIRE RANGE

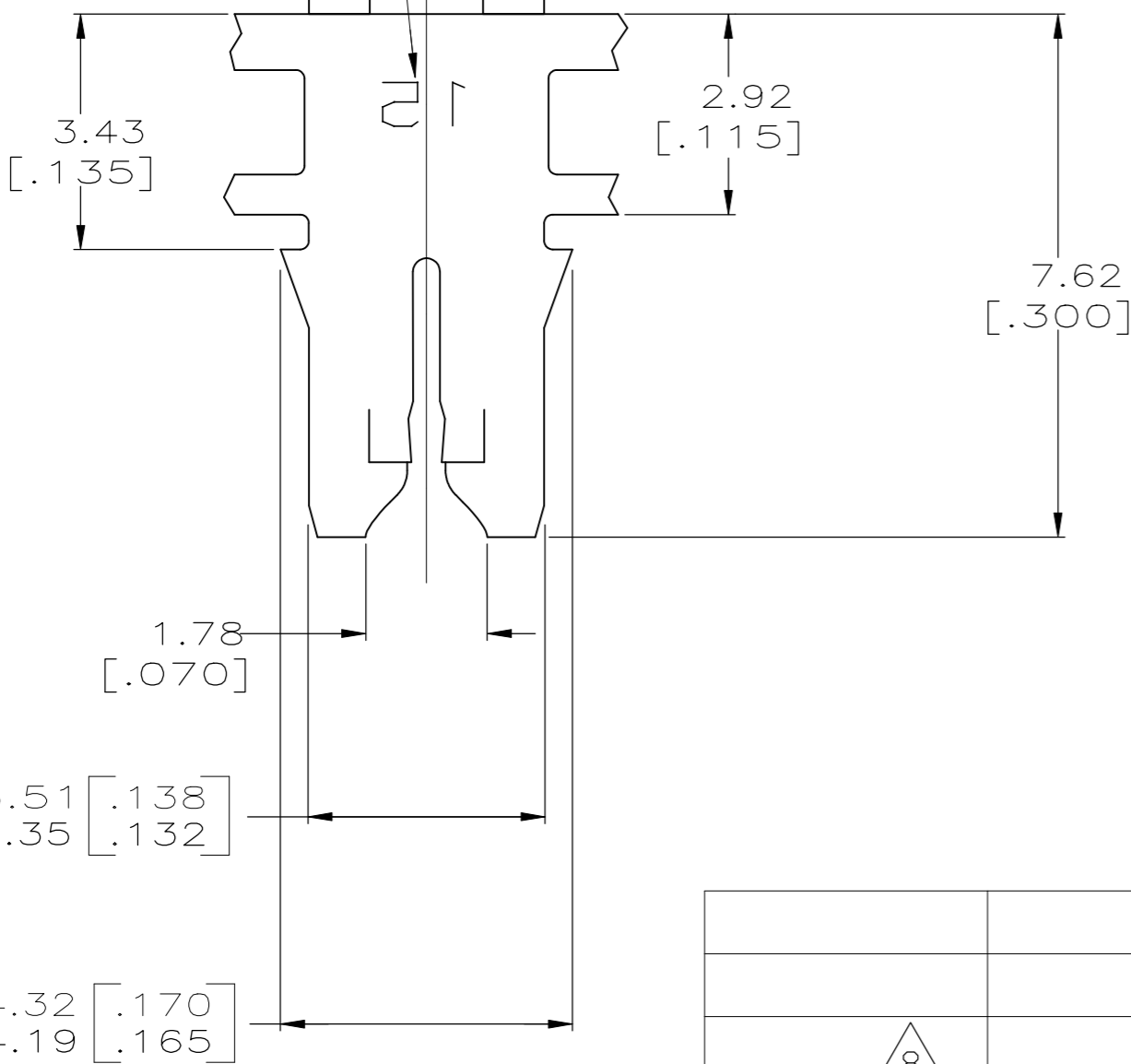

3.43
[.135] MAX
FREE STATE

32°±5°

0.38
[.015]

7.87
[.310]

0.406±0.025
[.016±.001]

3.05 [.120]
2.95 [.116]

- 1 CONTINUOUS STRIP ON REELS WITH TERMINALS LOCATED ON 5.59±0.08 [.220±.003] CENTERS.
- 2 SLOT ACCEPTS 0.64–0.81mm [#22–#20] AWG COPPER MAGNET WIRE. A SINGLE WIRE ONLY. SLOT ACCEPTS 0.72–0.91mm [#21–#19] AWG ALUMINUM MAGNET WIRE. ALUMINUM WIRE RANGE APPLIES FOR POST-TIN PLATED VERSIONS ONLY.
- 3 POKE-IN ACCEPTS A 0.81–1.02mm [#20–#18] AWG SOLID OR FUSED STRANDED LEAD WIRE.
- 4 0.0010 [.000040] MIN TIN.
- 5 VARNISH RESIST OVER 0.0010 [.000040] MIN TIN.
- 6 SPECIAL REEL QUANTITY FOR SPAIN PRODUCTION ONLY.
- 7 PRELIMINARY – NOT FOR PRODUCTION.
- 8 SUITABLE FOR COPPER MAGNET WIRES ONLY

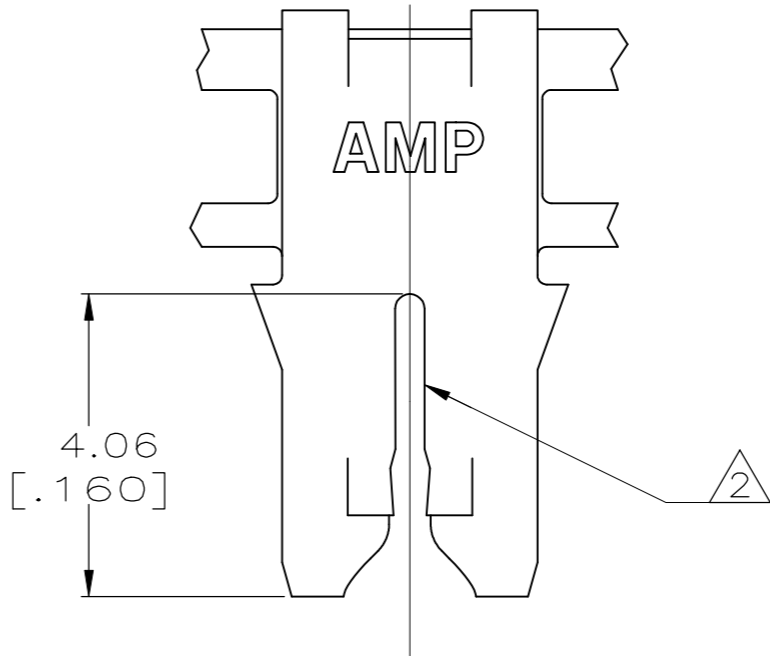

	STANDARD	SPLICE FREE	CARDBOARD REEL	BRASS	4	1–62420–8
	STANDARD	WELD	CARDBOARD REEL	PHOSPHOR BRONZE	4	1–62420–4
8	STANDARD	WELD	PLASTIC REEL	BRASS		62420–9
	REVERSE	WELD	CARDBOARD REEL	BRASS	4	7 62420–6
OBSOLETE	STANDARD	SPLICE FREE	PLASTIC REEL	BRASS	4	7 62420–5
OBSOLETE	STANDARD	WELD	CARDBOARD REEL	PHOSPHOR BRONZE	4	62420–4
OBSOLETE	STANDARD	WELD	CARDBOARD REEL	BRASS	4 6	62420–3
OBSOLETE	STANDARD	WELD	CARDBOARD REEL	BRASS	5	62420–2
	STANDARD	WELD	CARDBOARD REEL	BRASS	4	62420–1
REMARKS	REELING DIRECTION	SPLICE	REELING MATERIAL	MATERIAL	FINISH	PART NO.

D

C

B

A