

3 In case that the application demands a high level of reliability, such as automotive, please contact a company representative for further information.

COUNT	DESCRIPTION OF REVISIONS	BY	CHKD	DATE	COUNT	DESCRIPTION OF REVISIONS	BY	CHKD	DATE
△				..	△				..
△				..	△				..
△				..	△				..

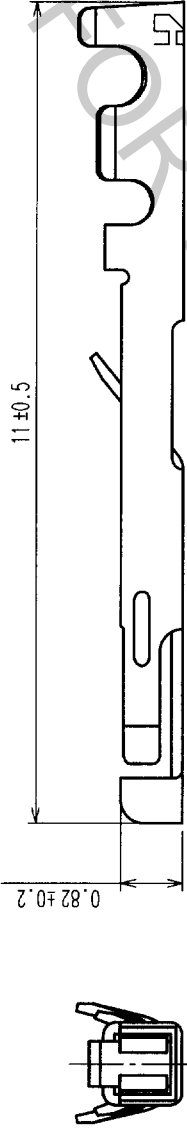

B-B (20 : 1)      A-A (20 : 1)

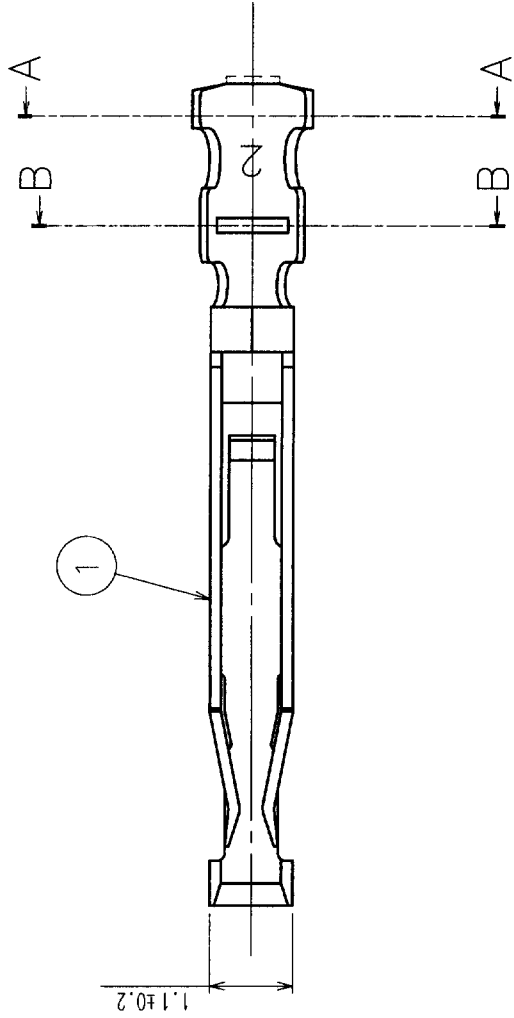
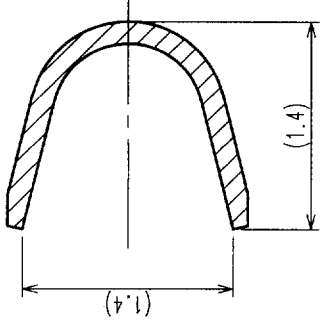
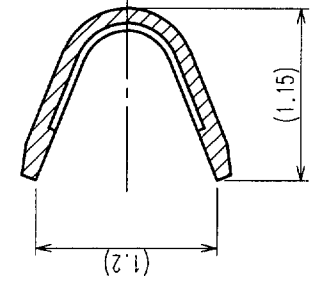

3 > FIG.1 RECOMMENDED CABLE PREPARATION DIMENSIONS

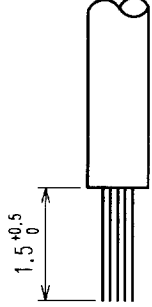

- NOTES    1 THIS PRODUCT IS APPLY TO THE WIRE 26-30 AWG(WIRE JACKET DIAMETER  $\phi$ 1 MAX).  
2 APPLICABLE OPERATION CRIMP TOOL:HT102/HR30-1  
3 > RECOMMENDED CABLE PREPARATION DIMENSIONS ARE SHOWN IN FIG.1.  
4 PER PACK:100 CONTACTS

1		PHOSPHOR BRONZE		SELECTIVE GOLD PLATING							
NO.		MATERIAL		FINISH, REMARKS		NO.		MATERIAL		FINISH, REMARKS	
CODE NO. (OLD)						DRAWN		DESIGNED		CHECKED	
						H. Zemba		H. Zemba		E. Kunii M. Yoshida	
						01.01.05		01.01.05		01.01.05	
								PART NO.		HR30-SC-111	
								DRAWING NO.			
								EDC3-112590			
								SCALE			
								10 : 1			
								UNITS			
								mm			
								HIROSE ELECTRIC CO., LTD			
								CODE NO.		CL130-0023-6	
										1 / 1	