

HARDWARE OPTIONS

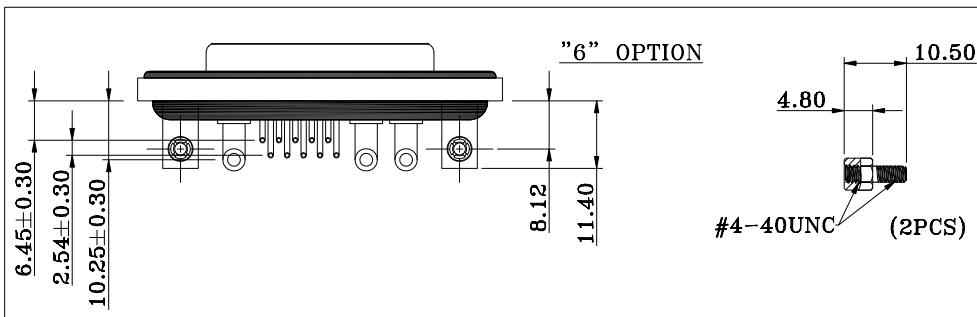
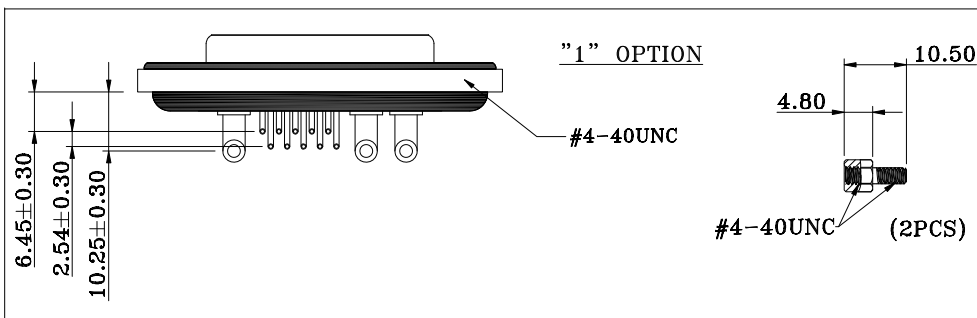

NOTE:

MATERIAL

HOUSING
 FLANGE
 CONTACT
 SHELL
 O-RING
 SEALING COMPOUND
 HARDWARE

PBT UL94V-0, BLACK
 PBT UL94V-0, BLACK
 BRASS, PLATING P/N KEY BELOW
 STEEL, NICKEL
 SILICONE
 EPOXY
 BRASS; NICKEL PLATED

ELECTRICAL

SIGNAL CONTACT RATED CURRENT
 POWER CONTACT RATED CURRENT
 VOLTAGE
 INSULATOR RESISTANCE
 SIGNAL CONTACT RESISTANCE
 POWER CONTACT RESISTANCE
 WATER PROOF

5A
 P/N KEY BELOW
 1000 VAC 1 MIN
 5 GOhms MIN.
 10 mOhms MAX.
 1.0 mOhms MAX.
 IP67

ENVIRONMENT

OPERATION TEMPERATURE

-25°C TO +85°C

CDFR13W3213LYYY

SERIES _____
 CDF = COMBO DSUB FLANGE
 CONTACT TYPE _____
 R = RIGHT ANGLE PCB MOUNT
 POSITION _____
 13W3
 GENDER _____
 2 = FEMALE
 POWER CONTACT AMPERAGE _____
 2 = 20 AMPS
 4 = 40 AMPS
 HARDWARE OPTIONS _____
 1 = 4-40 THREADED INSERTS/4-40 JACKSCREWS
 6 = 4-40 THREADED BRACKETS &
 BOARD LOCKS/4-40 JACKSCREWS
 CONTACT PLATING OPTIONS _____
 1 = GOLD FLASH
 2 = 30u" GOLD PLATING

RoHS COMPLIANT



THESE DRAWINGS AND SPECIFICATIONS ARE THE PROPERTY OF NorComp AND SHALL NOT BE REPRODUCED, COPIED OR USED AS THE BASIS FOR THE MANUFACTURE OR SALE OF APPARATUS WITHOUT WRITTEN PERMISSION.

DRAWN:

J. KADEL

DATE:

04/27/2020

TOLERANCES

X. ±0.40
 .X ±0.30
 .XX ±0.20
 .XXX ±0.10

UNITS = mm

DO NOT SCALE FROM DRAWING

NorComp

SCALE:

NTS

SHEET

1

OF

2

REV

0

DWG NO.

CDFR13W3213LYYY

****Ø3.20MM HOLES NOT NEEDED FOR "1" HARDWARE OPTION**

20 AMP CONFIGURATION

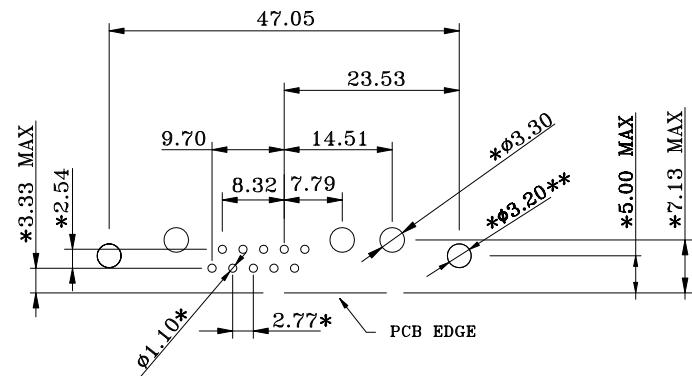

40 AMP CONFIGURATION

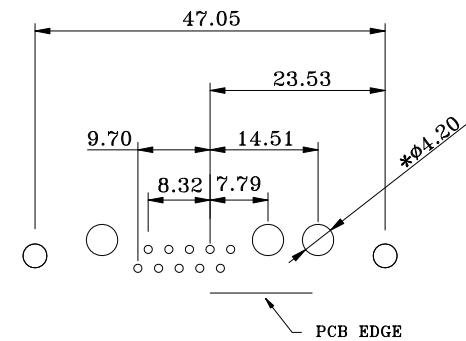

RECOMMENDED PCB LAYOUT

*TYPICAL // HOLE SIZE MAY NOT BE SUITABLE FOR YOUR
SPECIFIC APPLICATION

RoHS COMPLIANT



THESE DRAWINGS AND SPECIFICATIONS ARE THE PROPERTY OF NorComp AND SHALL NOT BE REPRODUCED, COPIED OR USED AS THE BASIS FOR THE MANUFACTURE OR SALE OF APPARATUS WITHOUT WRITTEN PERMISSION.

DRAWN:

J. KADEL

DATE: 04/27/2020

TOLERANCES

X.	± 0.40
.X	± 0.30
.XX	± 0.20
.XXX	± 0.10

UNITS = mm

DO NOT SCALE FROM DRAWING

NorComp

SCALE:
NTS

SHEET 2 OF 2

REV
0

DWG NO.

CDFR13W3213LYYY