

LOC	DIST	REVISIONS				
G	14	P	LTR	DESCRIPTION	DATE	DWN
						APVD
			T2	REVISED PER ECO-11-004587	11MAR11	RK HMR

AMP  
WIRE RANGE

8 AWG  
SOLID OR STRANDED

- 1

STAMP AMP 8\* APPROX AS SHOWN
- 2

UL LISTED E13288, 8 AWG STRANDED
- 3

CSA CERTIFIED LR7189, 8 AWG SOLID OR STRANDED
- 4

MILITARY MS20659-141 CLASS 2
- 5

SUPERSEDED BY 8-33461-1
- 6

TIN PLATE 0.00254 [.000100] MIN THK PER ASTM B545
- 7

TIN-LEAD (60-40) PLATE 0.00254 [.000100] MIN THK PER SAE-AMS-P-81728
- 9

PRELIMINARY - NOT FOR PRODUCTION

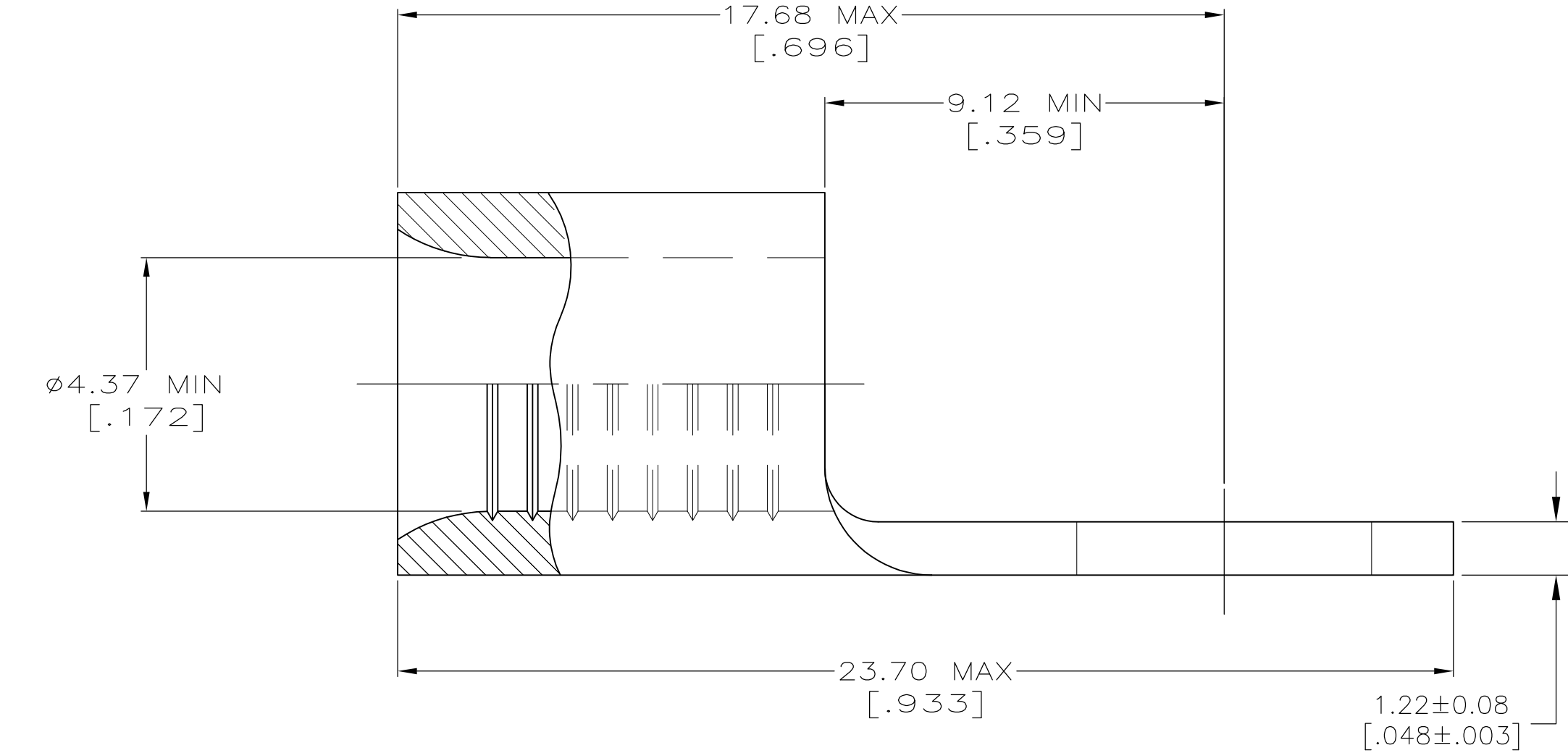
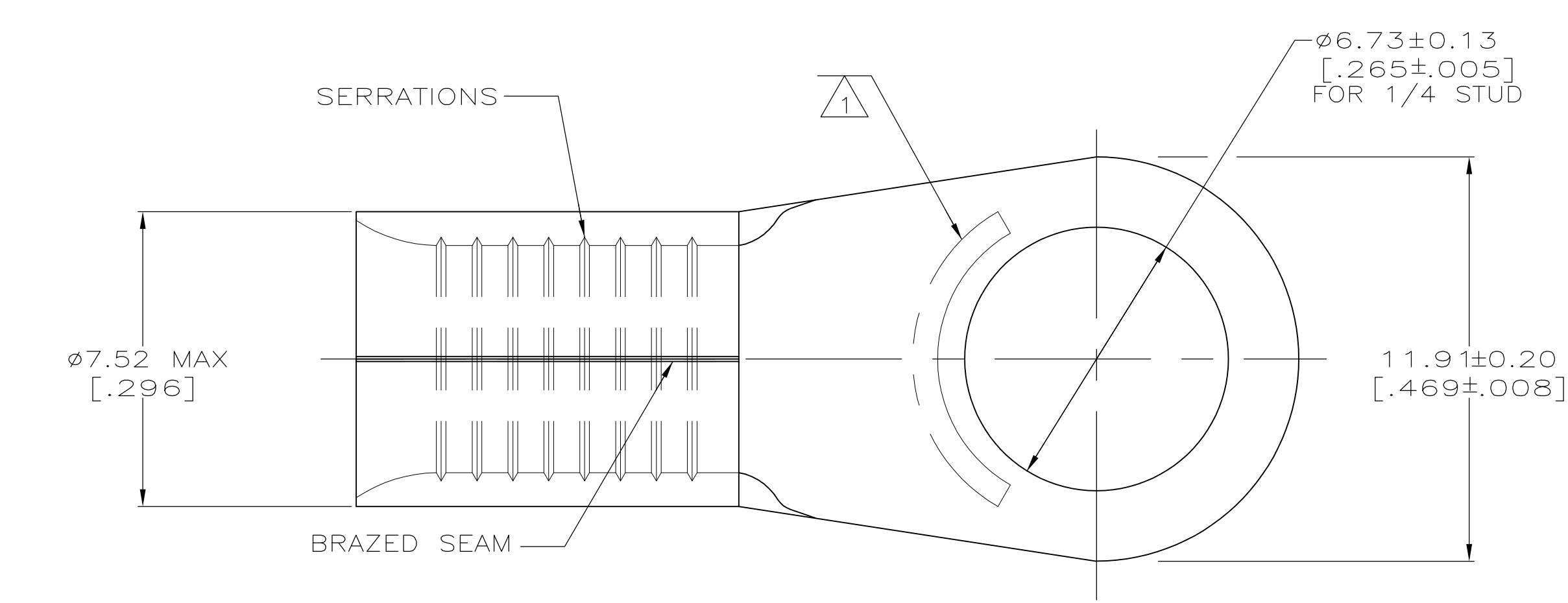

AMP INCORPORATED CUSTOMER SERVICE SYSTEMS			MAX RECOMMENDED OPERATING TEMPERATURE: 170°C MAX
FOR ADDITIONAL PRODUCT INFORMATION OR COPIES OF DRAWINGS AND TECHNICAL DOCUMENTS	PRODUCT INFORMATION CENTER 1-800-522-6752	VOLTAGE RATING: N/A	
FOR APPLICATION TOOLING INFORMATION	TOOLING ASSISTANCE CENTER 1-800-722-1111	CIRCULAR MIL AREA: 6.64-10.5mm² [13,100-20,800] SOLID OR STRANDED	
FOR ORDER ENTRY	1-800-526-5142	THIS DRAWING IS A CONTROLLED DOCUMENT FOR AMP INCORPORATED. IT IS SUBJECT TO CHANGE AND THE CONTROLLING ENGINEERING ORGANIZATION SHOULD BE CONTACTED FOR THE LATEST REVISION.	

OBSOLETE	<div>2</div> <div>3</div>	<div>6</div>	25	LOOSE PIECE, BAG	<div>8-33461-5</div>
	<div>2</div> <div>3</div>	<div>6</div>	50	LOOSE PIECE, BOX	<div>9</div> 8-33461-2
	<div>2</div> <div>3</div>	<div>6</div>	100	LOOSE PIECE, BOX	8-33461-1
	<div>2</div> <div>3</div>	<div>6</div>	1000	33461 TAPE MOUNTED ON 30.48[1.200] CENTERS	2-33461-3
	<div>2</div> <div>3</div> <div>4</div>	<div>6</div>	1500	33461 TAPE MOUNTED ON 15.24[.600] CENTERS	2-33461-2
	---	<div>7</div>	50	LOOSE PIECE	<div>9</div> 33461-1
	<div>2</div> <div>3</div> <div>4</div>	<div>6</div>	100	LOOSE PIECE	33461
APPROVALS		FINISH	QTY	PACKAGE TYPE	PART NO.

THIS DRAWING IS A CONTROLLED DOCUMENT.			DWN TA BRINKMAN 3-24-93	TE Connectivity		
DIMENSIONS: INCHES			CHK DA PATTERSON 3-24-93			
			APVD JL MECKLEY 3-24-93	NAME		
			PRODUCT SPEC	TERMINAL, RING TONGUE, SOLISTRAND		
TOLERANCES UNLESS OTHERWISE SPECIFIED:			APPLICATION SPEC	SIZE	CAGE CODE	DRAWING NO
0 PLC ± - 1 PLC ± - 2 PLC ± - 3 PLC ± - 4 PLC ± - ANGLES ± -			FINISH	WEIGHT	RESTRICTED TO	
MATERIAL COPPER PER ASTM B-152 ANNEALED			-	-	A2 00779	C-33461
CUSTOMER DRAWING				SCALE	SHEET	REV
				8:1	1 OF 1	T2