

REVISIONS					
REV	ECO	DESCRIPTION	DATE	BY	APPR
01	-	PRELIMINARY DRAWING	08/AUG/19	PETER	TOMMY

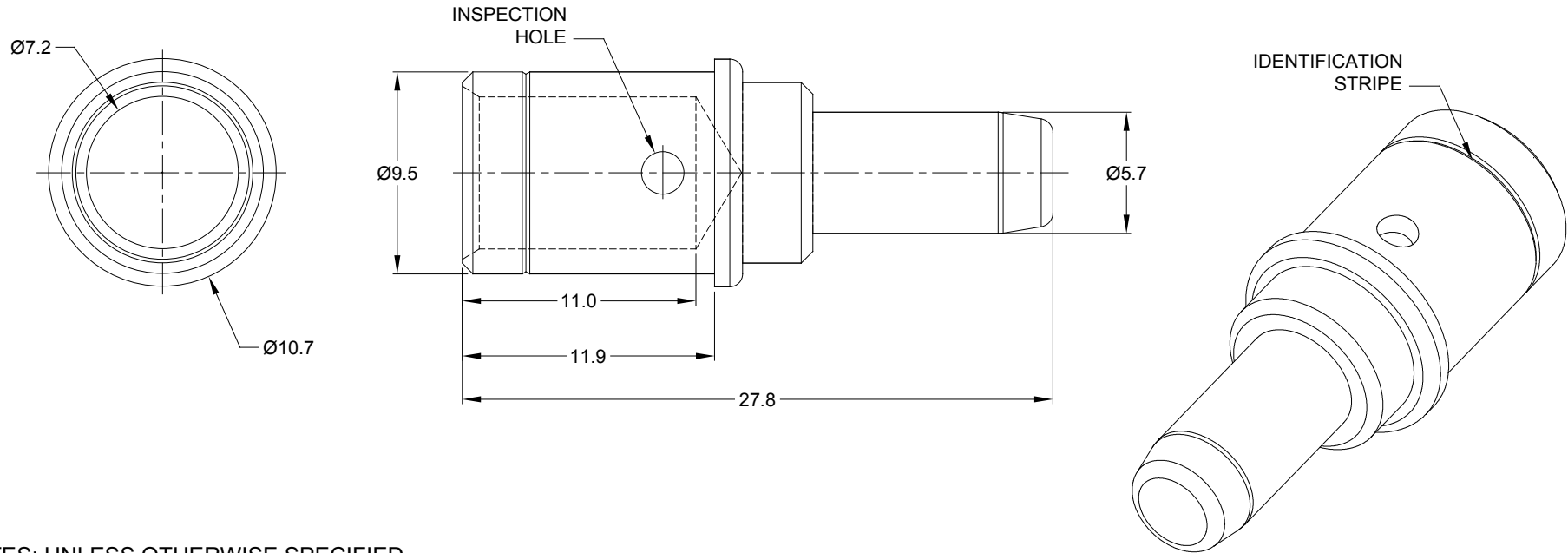

NOTES: UNLESS OTHERWISE SPECIFIED

1. MATERIAL: COPPER ALLOY; NICKEL PLATED

2. CONTACT SIZE: 4

3. SPECIFICATIONS:  
 3.1 CURRENT RATING: 100 AMP  
 3.2 CONTACT MILLIVOLT DROP: 60 MILLIVOLT DROP @ 100 AMP TEST CURRENT.  
 3.3 ROHS COMPLIANT

4. RECOMMENDED WIRE RANGE: 4 AWG (25.0~21.0mm<sup>2</sup>)

5. ALL DIMENSIONS ARE FOR REFERENCE USE ONLY

		AT60-203-04141-4			
		PART NUMBER		DESCRIPTION	
				ITEM	
QUANTITY		MATERIALS LIST			
<div>UNLESS OTHERWISE SPECIFIED</div> <div>1) All dimensions are in metric(mm). 2) Tolerances are as follows: 1 PL DEC ±0.30 2 PL DEC ±0.15 3 PL DEC ±0.08</div> <div>3) Note reference = <div><div>x</div></div></div>		<div>SIGNATURES</div> <div>DRAWN: PETER.YANG</div> <div>CHECKED: ORION.LI</div> <div>ENGINEER:</div> <div>APPROVAL: TOMMY.XIE</div> <div>CUSTOMER:</div> <div>THIS DRAWING IS SUPPLIED FOR INFORMATION ONLY. DESIGN FEATURES, SPECIFICATIONS AND PERFORMANCE DATA SHOWN HEREON ARE THE PROPERTY OF THE AMPHENOL CORPORATION. NO RIGHTS OF REPRODUCTION ARE IMPLIED. ALL DIMENSIONS ARE SUBJECT TO NORMAL MANUFACTURING VARIATIONS.</div>		<div>DATE</div> <div>08/AUG/19</div> <div>08/AUG/19</div> <div></div> <div>08/AUG/19</div> <div></div>	
MATERIAL SPECIFICATIONS:				<div>Amphenol</div> <div>Sine Systems - www.amphenol-sine.com 44724 Morley Drive Clinton Township, MI 48036</div>	
PROCESS SPECIFICATIONS:				CONTACT PIN,SIZE 4, 4 AWG	
NEXT ASS'Y:					