

# Product Sheet



**PART NUMBERS** APD9, APD11, APD12, APD14,  
APD19, APD20,APD21.



<b>Family</b>	AC boxes for control devices and signals
<b>Series</b>	AP containing boxes complete with cover
<b>Product type</b>	sized DIN rail
<b>Execution</b>	for APV / APS boxes

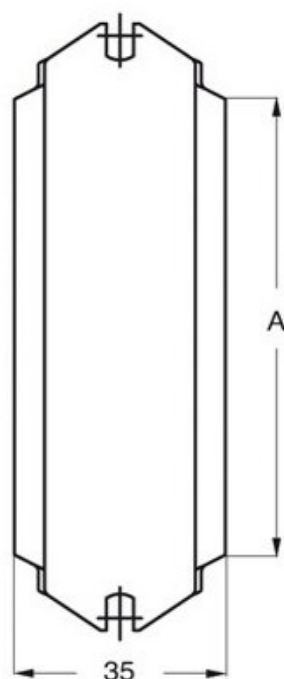
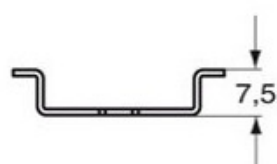

RAIL NO.	A	BOX NO.
APD 9	74	APV/S 9
APD 11	103	APV/S 11
APD 12	134	APV/S 12
APD 14	168	APV/S 14
APD 19	220	APV/S 19
APD 20	287	APV/S 20
APD 21	393	APV/S 21

The information and the dimensions contained are not binding and may be changed without prior notice.

The drawing's dimensions are in mm.