

Mar.1.2019 Copyright 2019 HIROSE ELECTRIC CO., LTD. All Rights Reserved.
In case that the application demands a high level of reliability, such as automotive,
please contact a company representative for further information.

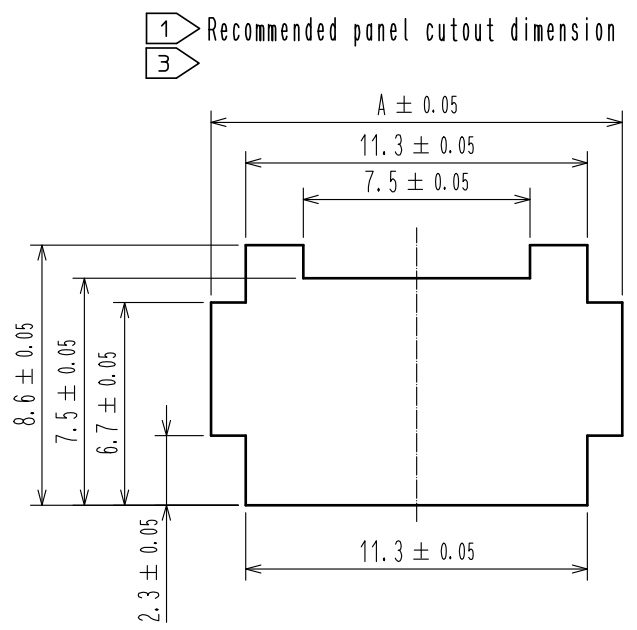

Panel thickness	A
0.5~0.8	13.6
0.9~1.3	14.1
1.4~1.8	14.5
1.9~2.3	14.9

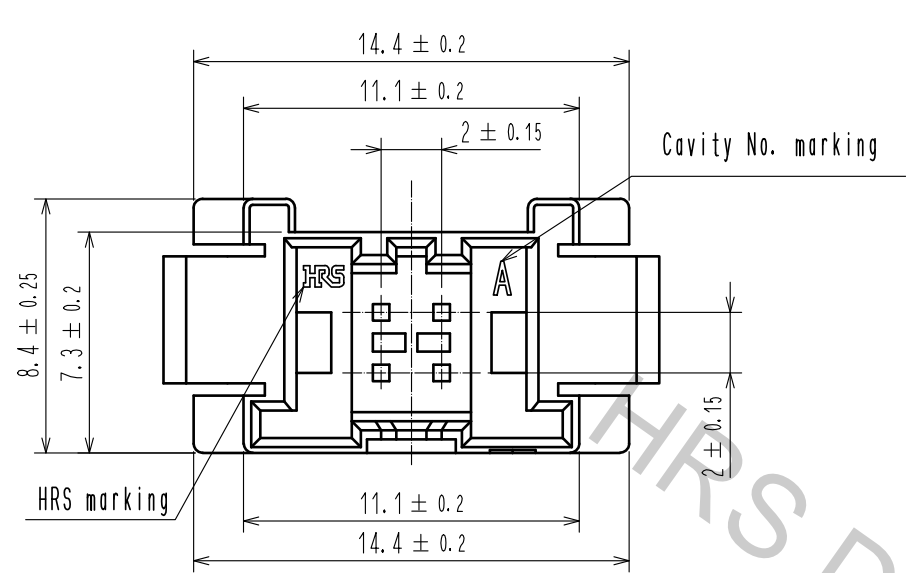
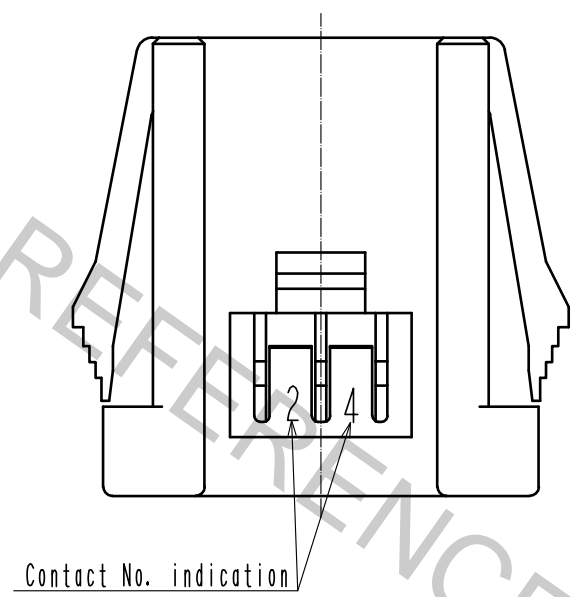
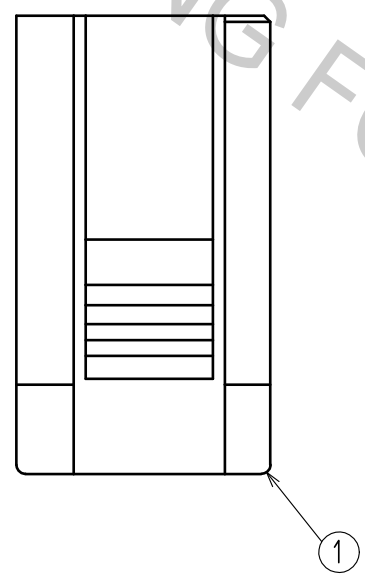
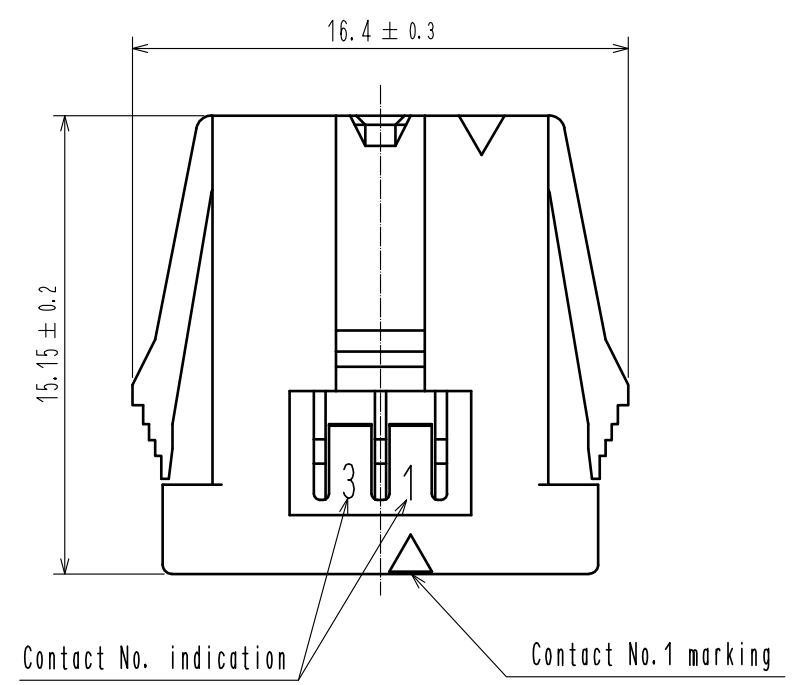

- Note
- 1 Please use non-radius side for the panel hooking area.
 - 2 Applicable panel thicknessing is 2.3 to 0.5 mm.
 - 3 Consult hirose for the other panel cutout designs than recommended one.
 - 4. Per pack : 100 pieces.
 - 5. UL(File No.E52653),
C-UL(File No.E52653) authorization article.



NO.				1				PBT				UL94V-0. BLACK			
MATERIAL				FINISH . REMARKS				MATERIAL				FINISH . REMARKS			
UNITS				SCALE				COUNT				DESCRIPTION OF REVISIONS			
mm				4 : 1				1				DIS-H-00004537			
HRS				HIROSE ELECTRIC CO., LTD.				APPROVED : HS. OKAWA				20160601			
								CHECKED : YN. TAKASHITA				20160601			
								DESIGNED : TT. OHSAKO				20160601			
								DRAWN : TT. OHSAKO				20160601			
												DRAWING NO.			
												EDC-366282-00-00			
												PART NO.			
												DF51-4DEP-2C			
												CODE NO.			
												CL543-5071-0-00			
												1/1			