

SPECIFICATIONS:  
MAKE-BEFORE-BREAK

LOC	DIST	REVISIONS					
		P	LTR	DESCRIPTION	DATE	DWN	APVD
AD	00		A	ECO 05 003709	23MAR06	BSV	MS

MATERIALS:  
ACTUATOR — NYLON 66 UL94V-0, BLACK  
FRAME — TIN PLATED STEEL  
TERMINAL BOARD — PHENOLIC LAMINATE UL94HB, NATURAL  
TERMINAL (SILVER) — COPPER ALLOY- SILVER OVER NICKEL PLATE  
TERMINAL (GOLD) — COPPER ALLOY- TIN OVER NICKEL PLATE  
FIXED CONTACT (SILVER) — COPPER ALLOY- SILVER OVER NICKEL PLATE  
FIXED CONTACT (GOLD) — COPPER ALLOY-GOLD OVER NICKEL PLATE  
MOVING CONTACT (SILVER) — COPPER ALLOY- SILVER OVER NICKEL PLATE  
MOVING CONTACT (GOLD) — COPPER ALLOY-GOLD OVER NICKEL PLATE  
DETENT BALL — STAINLESS STEEL  
COIL SPRING — TEMPERED STEEL WIRE  
SEAL — EPOXY

ELECTRICAL:  
CONTACT RATING — .4VA@20VDC OR PEAK AC (GOLD)  
300mA@125V AC (SILVER)  
INITIAL CONTACT RESISTANCE — 30milliohm max.  
FINAL CONTACT RESISTANCE — 100milliohm max> (AFTER TEST)  
INSULATION RESISTANCE — 1,000Megohms min.”  
DIELECTRIC STRENGTH — 500V RMS@SEA LEVEL  
LIFE EXPECTANCY — 15,000 CYCLES MIN.”

MECHANICAL:  
ACTUATION FORCE — 600±300 GRAMS  
TRAVEL — 2.00±0.51[.079±.020]

ENVIRONMENTAL:  
OPERATING TEMPERATURE — -20 TO +85 DEGREES C  
STORAGE TEMPERATURE — -40 TO +100 DEGREES C  
RESISTANCE TO SOLDER HEAT PER 109-202, CONDITION B  
SOLDERABILITY PER EIA- 364-52, CLASS 2, CATEGORY 1, 95% MIN  
COVERAGE

- NOTES:
- ALL MATERIALS AND FINISHES SHALL COMPLY WITH EU  
DIRECTIVE 2002 95/EC OF 27JAN2003 (ROHS).
  - ANTI SOLDER WICK SEAL AT TERMINAL TO BOARD INTERFACE.

1,3&5,7	2,3&6,7	3,4&7,8	DP3T	GOLD	MSSA2350G04	1825198-2
1,3&5,7	2,3&6,7	3,4&7,8	DP3T	SILVER	MSSA235004	1825198-1
			TYPE	CONTACT PLATING	ALCO P/N	TYCO P/N
LEFT	CENTER	RIGHT				
ACTUATOR POSITION						

THIS DRAWING IS A CONTROLLED DOCUMENT.		DWN	20JUN96		<div><div><div>tyco</div><div>Electronics</div></div><div>Tyco Electronics Corporation Harrisburg, PA 17105-3608</div></div>					
		TRU-D								
		CHK	-							
		APVD	-							
DIMENSIONS: mm [INCHES]		TOLERANCES UNLESS OTHERWISE SPECIFIED:		NAME						
	0 PLC	±	-	PRODUCT SPEC						
	1 PLC	±	-	-						
	2 PLC	±	0.25[.010]	APPLICATION SPEC						
	3 PLC	±	-	-						
	4 PLC	±	-	-						
MATERIAL		ANGLES		SIZE	CAGE CODE	DRAWING NO	RESTRICTED TO			
SEE SPECIFICATIONS		FINISH		WEIGHT	A2 00779 C=1825198		-			
				CUSTOMER DRAWING				SCALE	SHEET	REV
								2:1	1 of 1	A

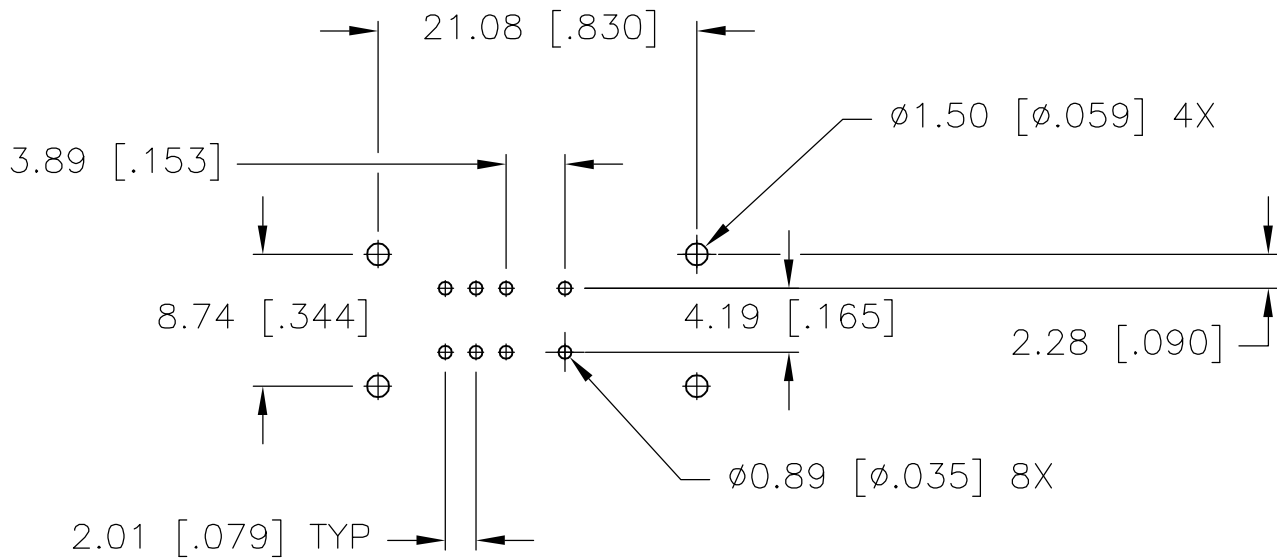
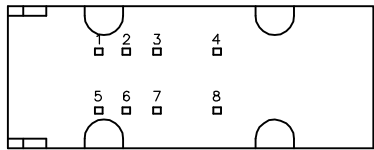
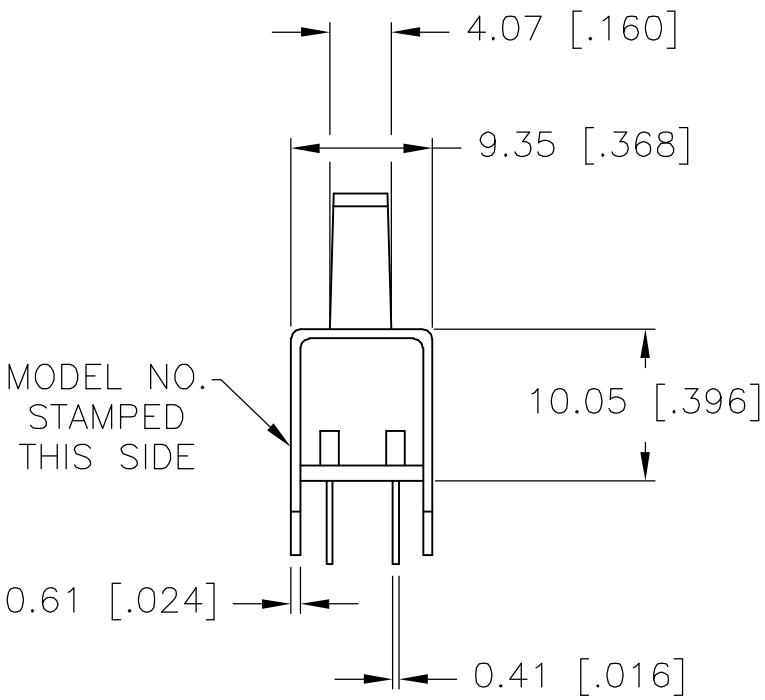
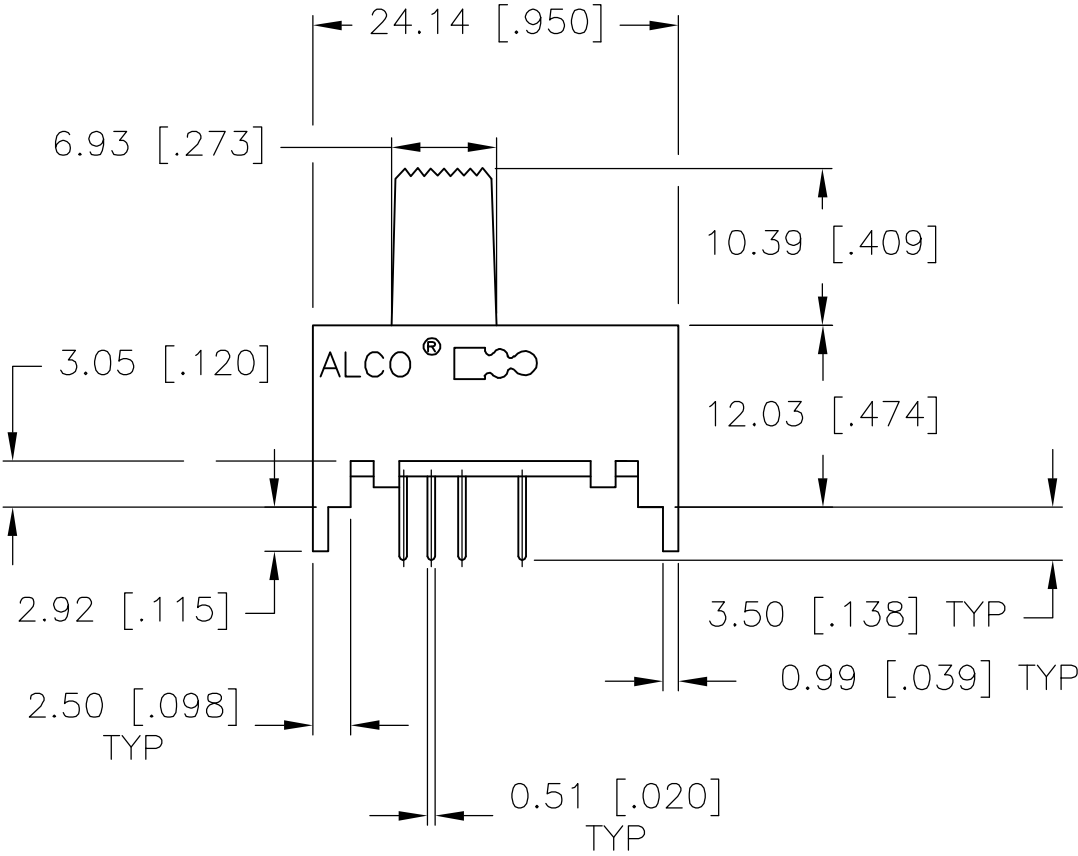
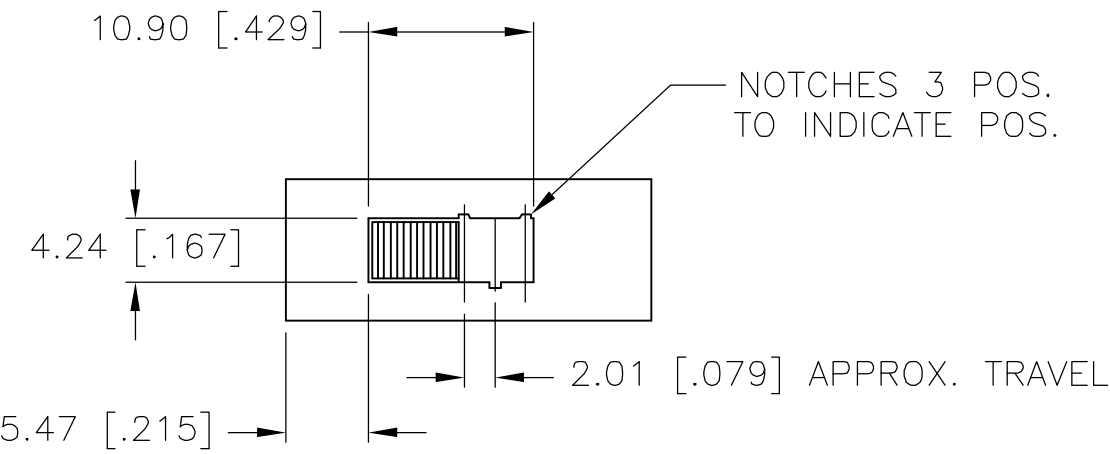

RECOMMENDED HOLE LAYOUT  
TOLERANCE ±.002 UNLESS OTHERWISE NOTED