

HEAVY DUTY ENCLOSURE IP66 RATED SEAL

- SILICONE RUBBER SPONGE 01-255FR
- HARDNESS SHORE A 6 +/-3 (ON 10mm THICK MATERIAL)
- COLOUR - CREAM/WHITE
- ADHESIVE BACKED - 01-255SAB
- COMPRESSION SET (50%) (22 HRS @ 70°C) 9+/-5
- EXCELLENT RESISTANCE TO OZONE, OXIDATION, UV LIGHT CORONA DISCHARGE, COSMIC RADIATION, IONISING RADIATION AND WEATHERING IN GENERAL
- SUITABLE FOR CONTINUOUS USE AT TEMPERATURES UP TO 240°C OR +300°C UP TO 10 HRS. ALTERNATIVELY -80°C
- ASTM D746
- <PARA >DENSITY (Kg.m³) 200/300
- THERMAL CONDUCTIVITY 6.4 x 10 W.m<sup>-1</sup>.K<sup>-1</sup>

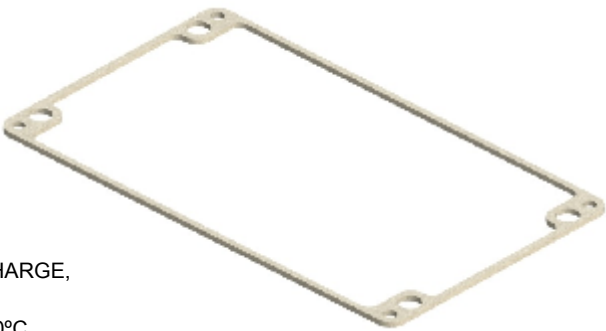

PICTURE FOR ILLUSTRATION ONLY

SIZE CODE	SEAL PART No.
121208	486-S66-1212
121209	486-S66-1212
130806	486-S66-1308
161609	486-S66-1616
221208	486-S66-2212
221209	486-S66-2212
261609	486-S66-2616
261612	486-S66-2616

Please select size code from below table

NOTE:

'IP' RATINGS ARE BASED ON TESTS CARRIED OUT ON DELTRON ENCLOSURES  
PLEASE CONTACT DEM FOR MORE INFORMATION OR CERTIFICATION

How to Work Out Deltron Enclosures Part Numbers

Heavy Duty

e.g. 487-261609E-68

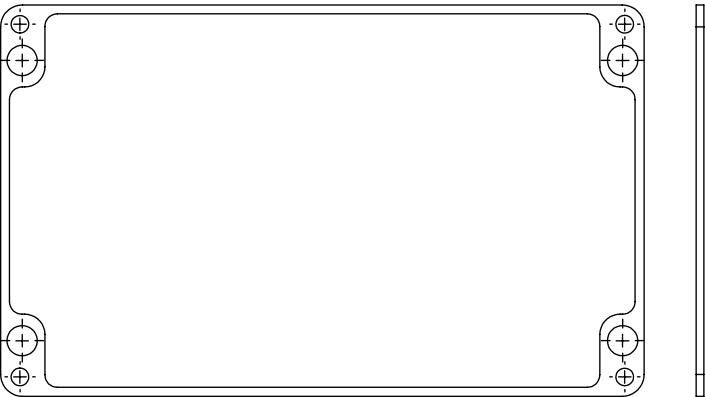

Series - (3 digits)	Size Identifier - (6 digits)	Coating Colour - (1 digit)	IP Rating - (2 digits)
XXX	XXXXXX	X	XX
SERIES CODE	SIZE CODE	COATING CODE	IP CODE
486 = No Coating	121208 = 125 x 125 x 80mm	Blank = No Paint (486)	Blank = No IP Rating
487 = Powder Coating	121209 = 125 x 125 x 90mm	E = Blk	66 = IP66
488 = Nylon Coating	130806 = 130 x 80 x 60mm	B = Blu	68 = IP68
	161609 = 160 x 160 x 90mm	A = Gry	
	221208 = 220 x 120 x 80mm		
	221209 = 220 x 120 x 90mm		
	261609 = 261 x 160 x 90mm		
	261612 = 260 x 160 x 120mm		