

A B C D E F G H

REVISIONS			
REV	DESCRIPTION, ECN, EAR NO.	DATE	APP'D
A	PROPOSAL	JUN23/14	L.CHAN
B	REVISE PROPOSAL	NOV08/14	L.CHAN

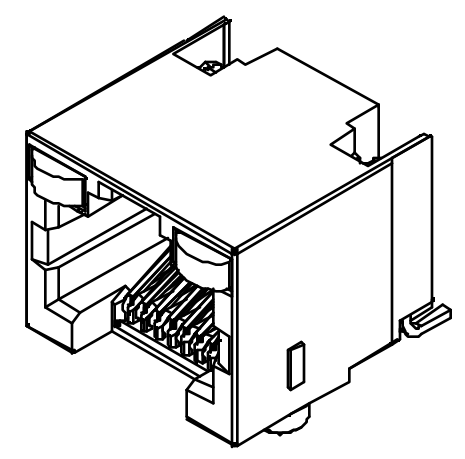

TYPICAL FOR SINGLE COLOUR LED

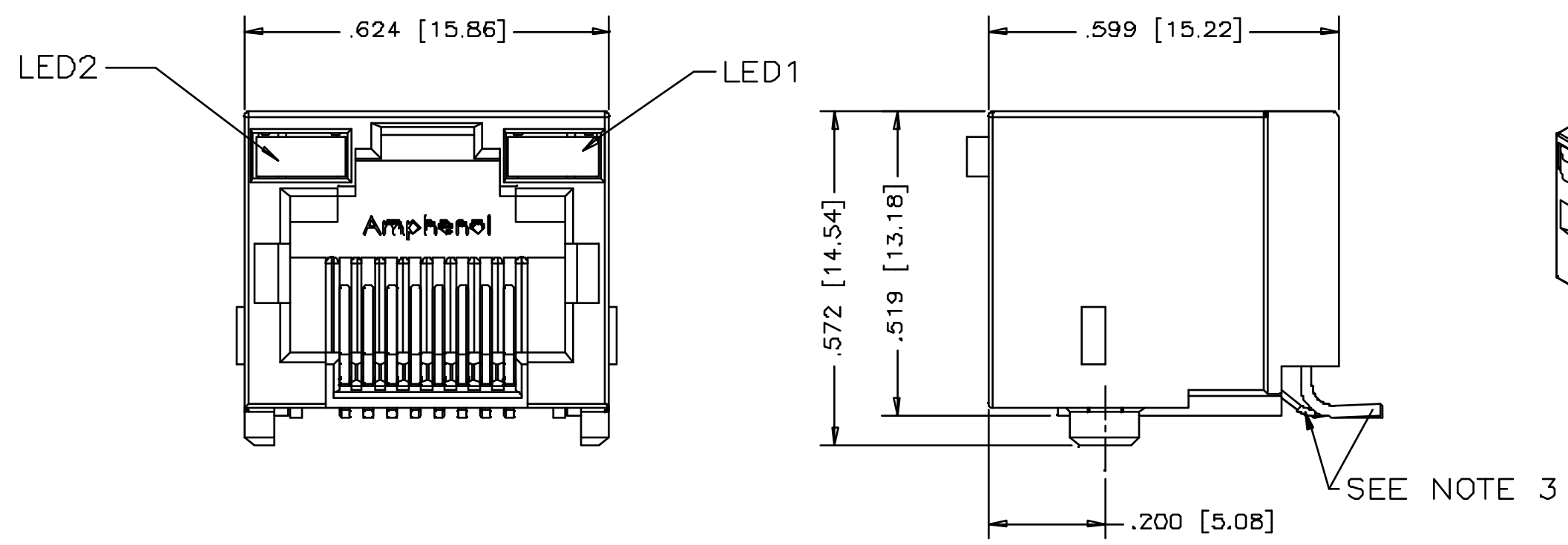
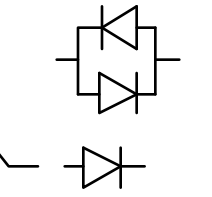

TYPICAL FOR BI-COLOUR LED

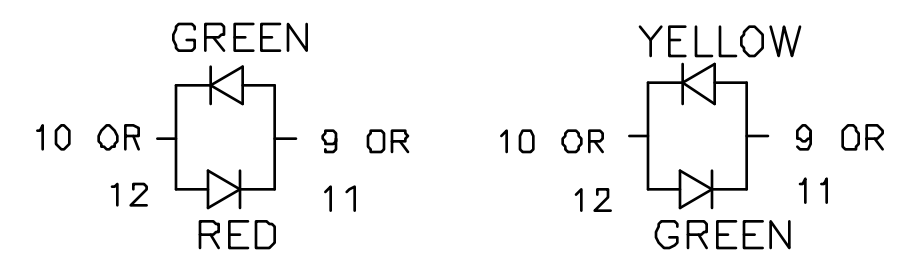
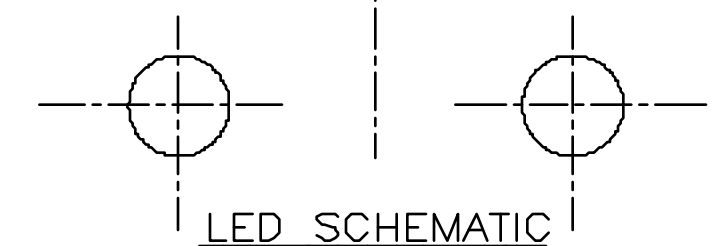
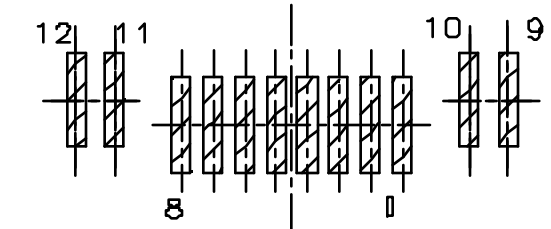
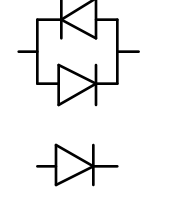

BI-COLOUR LED DETAIL
(RED/YELLOW AND GREEN/ORANGE LED'S ARE ALSO AVAILABLE)

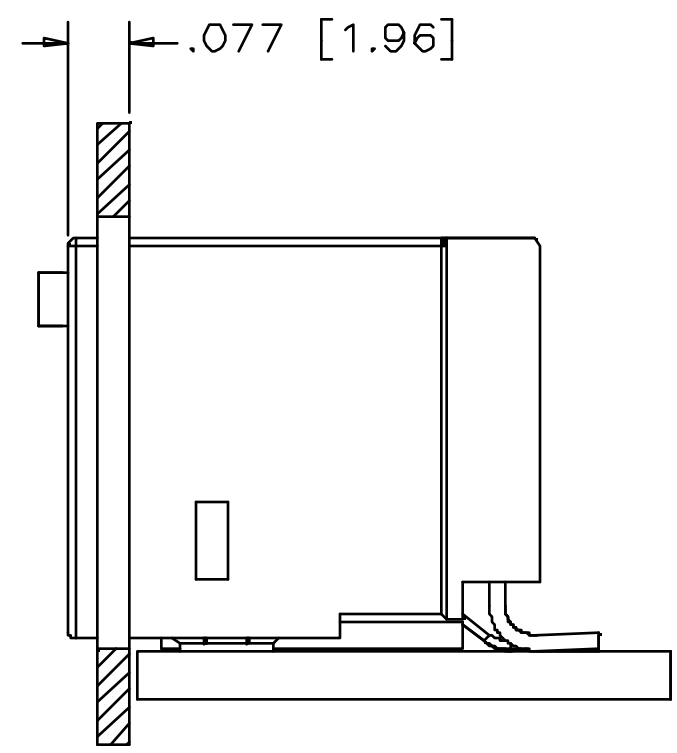
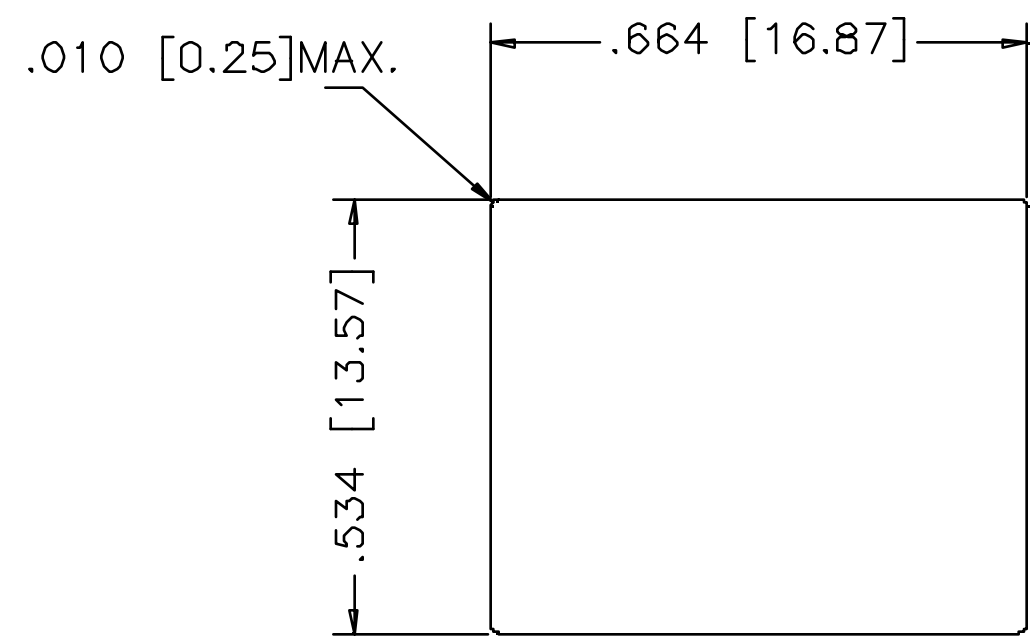
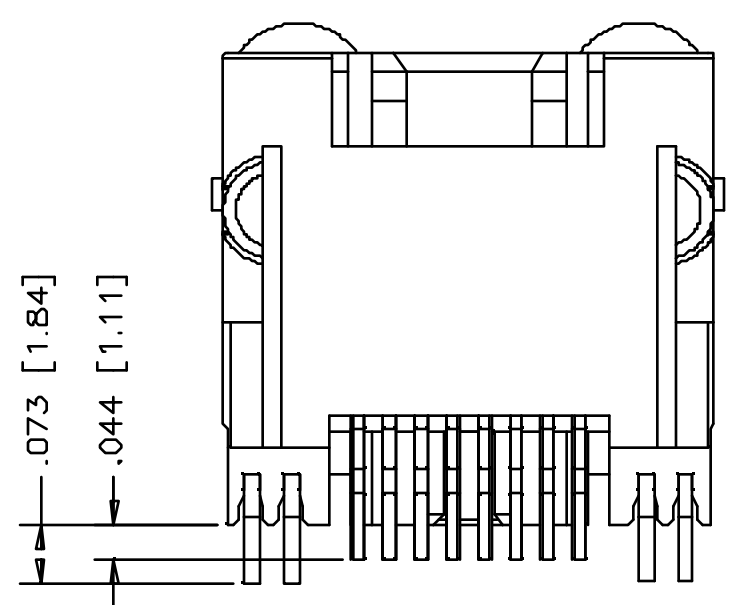

RECOMMENDED PANEL CUT-OUT

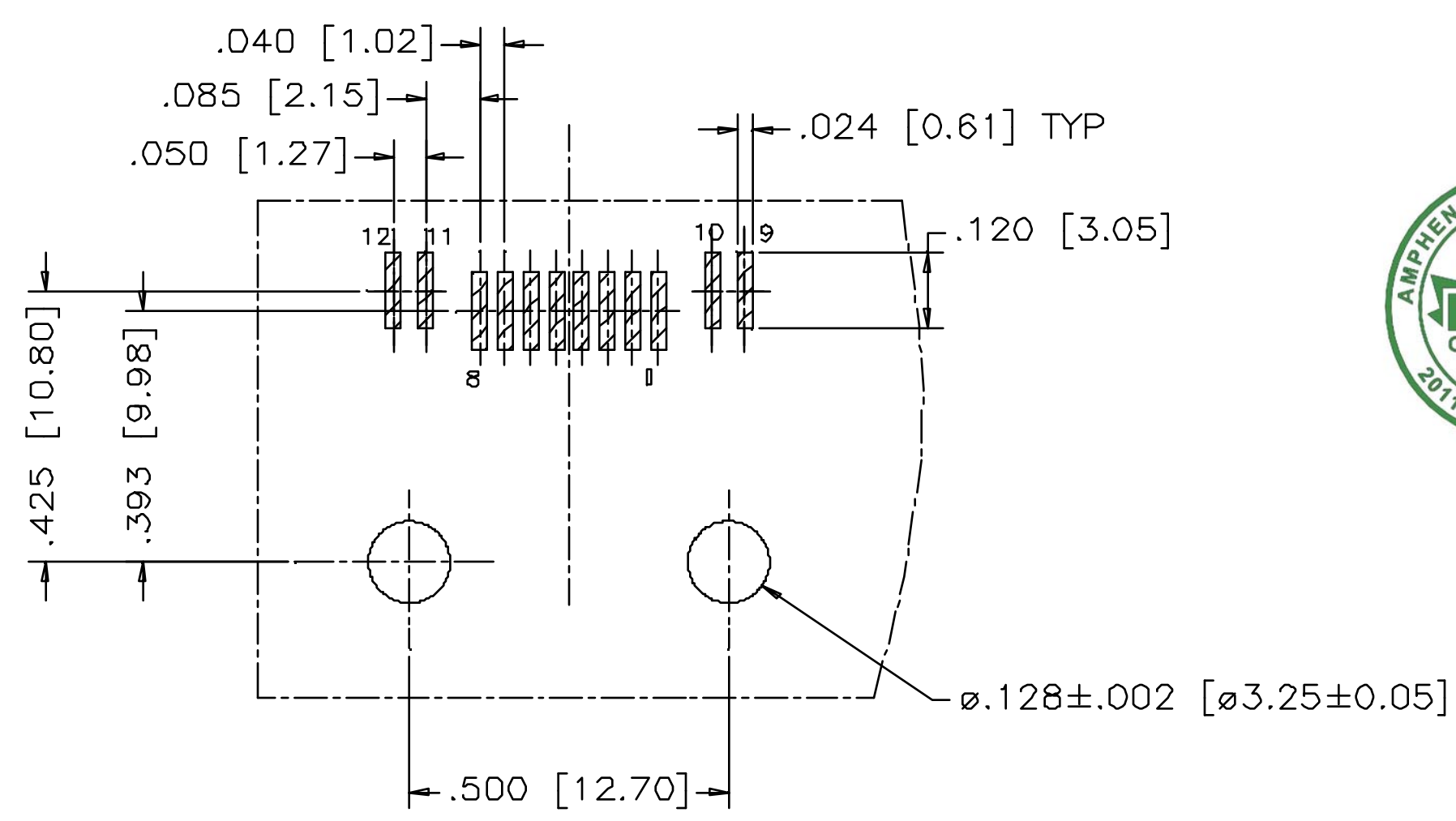

RECOMMENDED P.C.B. LAYOUT (COMPONENT SIDE OF BOARD)



- 1, MATERIALS:
- HOUSING: HIGH TEMPERATURE THERMOPLASTIC
FLAMMABILITY RATING UL 94V-0
COLOR: BLACK
- CONTACTS: PHOSPHOR BRONZE
PLATING: 50 u" MIN GOLD PLATING ON MATING AREA.
50 u" [1.27 MICRONS] MIN NICKEL UNDERPLATE.
100 u" [2.54 MICRONS] MIN MATTE-TIN OR GOLD FLASH ON CONTACT TAILS.
- 2, ALLOW 0.6% LED DEFECT RATE AFTER 260° IR REFLOW PROCESS
- 3, COPLANARITY SPECIFICATION:
THE MAXIMUM GAP BETWEEN ALL TERMINAL TAILS IS 0.10 [0.004]
- PART NUMBER: RJCSE-508X-01X
- REFER TO LED OPTIONS DRAWING

THIS DOCUMENT CONTAINS PROPRIETARY INFORMATION AND SUCH INFORMATION MAY NOT BE DISCLOSED TO OTHERS FOR ANY PURPOSE OR USED FOR MANUFACTURING PURPOSES WITHOUT WRITTEN PERMISSION FROM AMPHENOL CANADA CORP.

UNLESS SPECIFIED OTHERWISE		DRAWN	G.HSIA	JUN23/14	Amphenol Canada Corp. www.amphenolcanada.com			
PRIMARY UNITS INCHES		CHECKED						
SECONDARY MILLIMETERS		M.E. APP'D			SINGLE PORT SURFACE MOUNT JACK 8 POSITION, 8 CONTACTS, UNSHIELDED, WITH LED OPTIONS- RoHS COMPLIANT			
REFERENCE IN PARENTHESES		Q.A. APP'D						
1 DECIMAL PLACE 2 DECIMAL PLACES 3 DECIMAL PLACES ±0.015 ANGULAR DEGREES		DWG APP'D	L.CHAN	JUN23/14	DWG NO. P-RJCSE-508X-01X			
		ENG. REL. NO.						
		REF.			REV B			
		THIRD ANGLE PROJECTION						
		DO NOT SCALE DRAWING			CODE ID NO. 03554	DWG SIZE	SCALE	SHEET 1 OF 1