

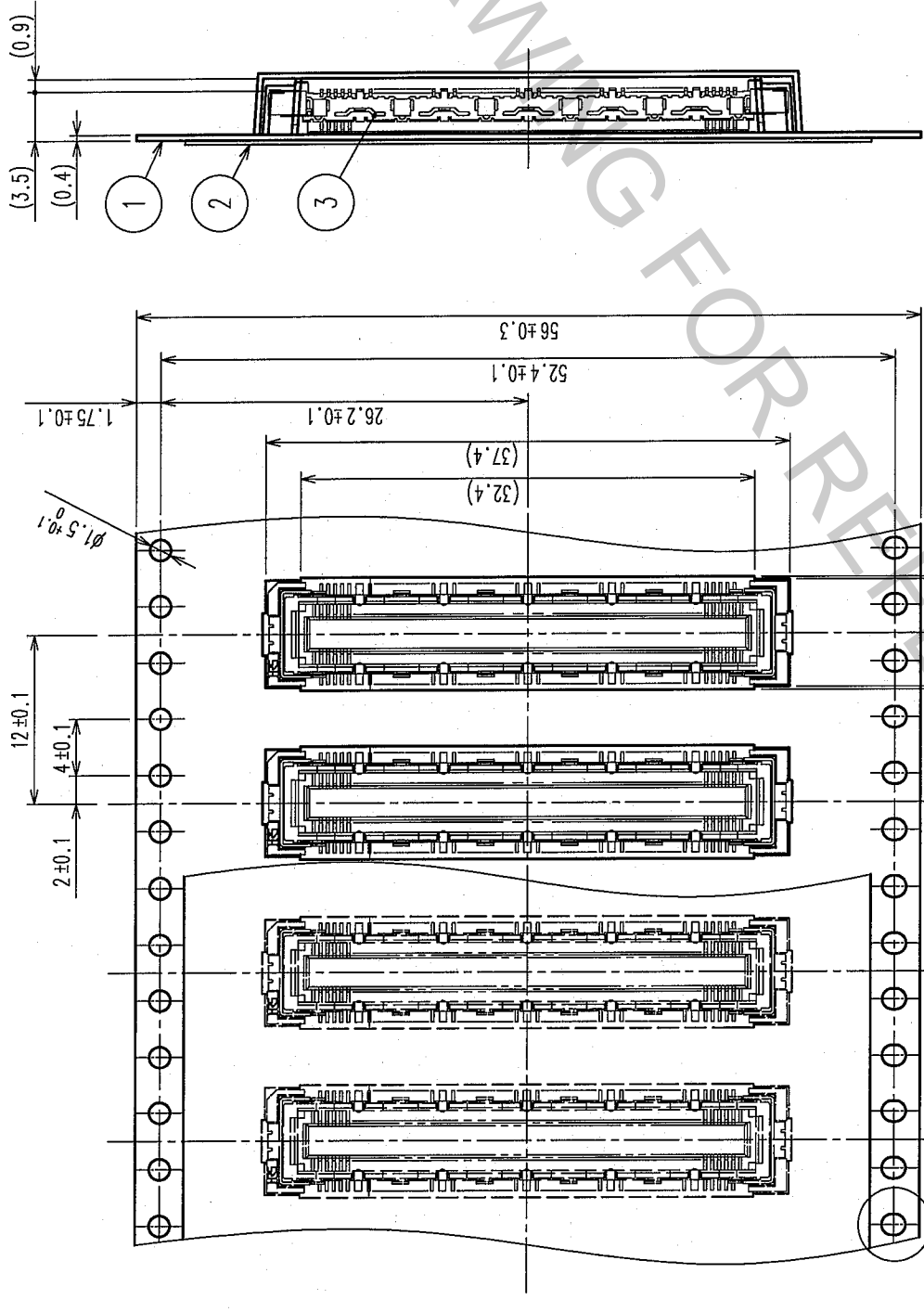

In case that the application demands a high level of reliability, such as automotive, please contact a company representative for further information.

REVISIONS	DATE	COUNT	DESCRIPTION OF REVISIONS	BY	CHKD	DATE
△	..	△				
△	..	△				
△	..	△				



REELED DIMENSION(Free)

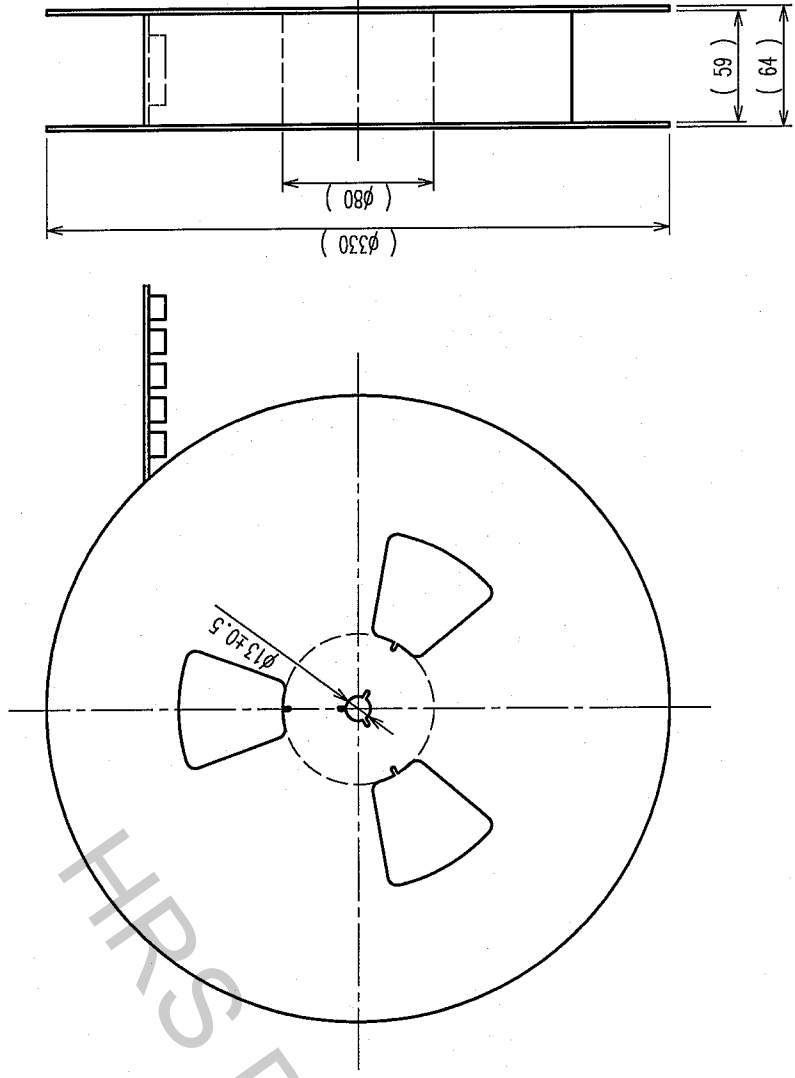

THE DIRECTION OF PULLING OUT

A(5:1)

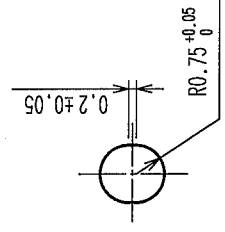

- NOTES
- 1 REEL: 1000 CONNECTORS.
  - 2 MINIMUM 10 COMPARTMENTS FROM BOTH REEL ENDS REMAIN EMPTY.
  - 3 THIS PRODUCT HAS NO POLARITY TO TAPE AND REEL PACKAGING.
  - 4 THE DIMENSIONS IN PARENTHESES ARE FOR REFERENCE.

2	POLYESTER	TOP COVER TAPE	3	(CONNECTOR)	FINISH, REMARKS
1	POLYSTYRENE	EMBOSSED CARRIER TAPE	3	(CONNECTOR)	FINISH, REMARKS
NO.	MATERIAL	FINISH, REMARKS	NO.	MATERIAL	FINISH, REMARKS
CODE NO. (OLD)	CL	DRAWN	DESIGNED	CHECKED	APPROVED
DRAWING FOR PACKING			DRAWING FOR PACKING		
DRAWING NO.			PART NO.		
EDC3-151977-21			FX10A-100S/10-SV(91)		
SCALE			CODE NO.		
2 : 1			CL573-0202-7-91		
UNITS			CL573-0202-7-91		
mm			CL573-0202-7-91		

TO	PCK		
----	-----	--	--