

5

4

3

2

1

受控 CONTROLLED DOCUMENT

编号 P/N	25-7035-CUST	版本 Rev	01	日期 Rel'd Date	Apr29,09
-----------	--------------	-----------	----	------------------	----------

DRAWING NO.

25-7035-CUST

REVISIONS

01

OFFICIAL RELEASE

03-10-09

Y

U

Y

U

T

H

Thomas
Chow

Description: F Conn. W/ 1/2 Ring RG-59 TFE

Part No: 25-7035

Application: For Thin Cable RG-59,62 Teflon

Crimp Tool: 24-7710 or 24-8866P

Impedance: 75 Ohms

Frequency Range: 0-750 MHz

Material: Body Brass Nickel plated

Nut Brass Nickel plated

Sleeve Brass Nickel plated

RoHS Compliance: Yes

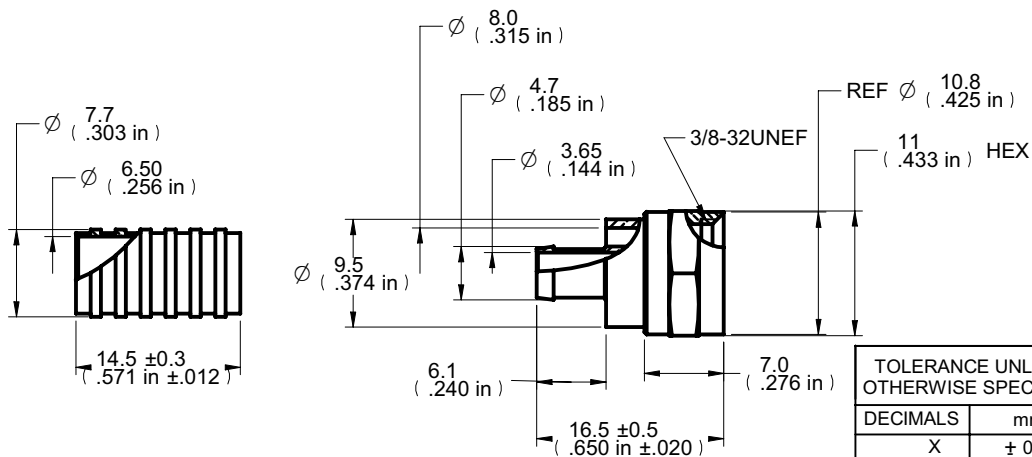
Technical Detail: Refer to Emerson Document P/N
25-0000

DIM OUTLINE

TOLERANCE UNLESS OTHERWISE SPECIFIED		DRAWN BY	DATE
DECIMALS	mm	BETTY.YU	03-10-09
X	± 0.5	CHECKED BY	DATE
X.X	± 0.3	BETTY.YU	03-10-09
X.XX	± 0.1	APPROVED BY	DATE
ANGLES	± 0.5°	THOMAS	03-10-09
		U/M	mm

THIS DRAWING WAS PRODUCED BY COMPUTER.
DO NOT SCALE DRAWING OR UPDATE MANUALLY.

 EMERSON Network Power		Connectivity Solutions	
TITLE			
F CONN. W/1/2 RING RG-59 TFE			
SHEET	DRAWING NO.	SIZE	
1 OF 1	25-7035-CUST	A	

CUSTOMER COPY