

NOTE 1. ( ) INDICATES THE REFERENCE DIMENSIONS.  
2. COLORS ARE SHOWN IN TABLE-1.  
3. PER PACK: 50 PIECES.

TABLE-1

PART No.	HRS No.	COLOR
TM21P-88P(11)	CL222-2862-9-11	LIGHT BEIGE
TM21P-88P(12)	CL222-2862-9-12	MEDIUM GRAY
TM21P-88P(13)	CL222-2862-9-13	BLACK
TM21P-88P(14)	CL222-2862-9-14	NATURAL LIGHT GRAY
TM21P-88P(15)	CL222-2862-9-15	RED
TM21P-88P(16)	CL222-2862-9-16	GREEN
TM21P-88P(17)	CL222-2862-9-17	BLUE
TM21P-88P(18)	CL222-2862-9-18	YELLOW
TM21P-88P(19)	CL222-2862-9-19	ORANGE
TM21P-88P(32)	CL222-2862-9-32	WHITE
TM21P-88P(33)	CL222-2862-9-33	VIOLET
TM21P-88P(34)	CL222-2862-9-34	PINK

ATTACHED HOOD CLOSED

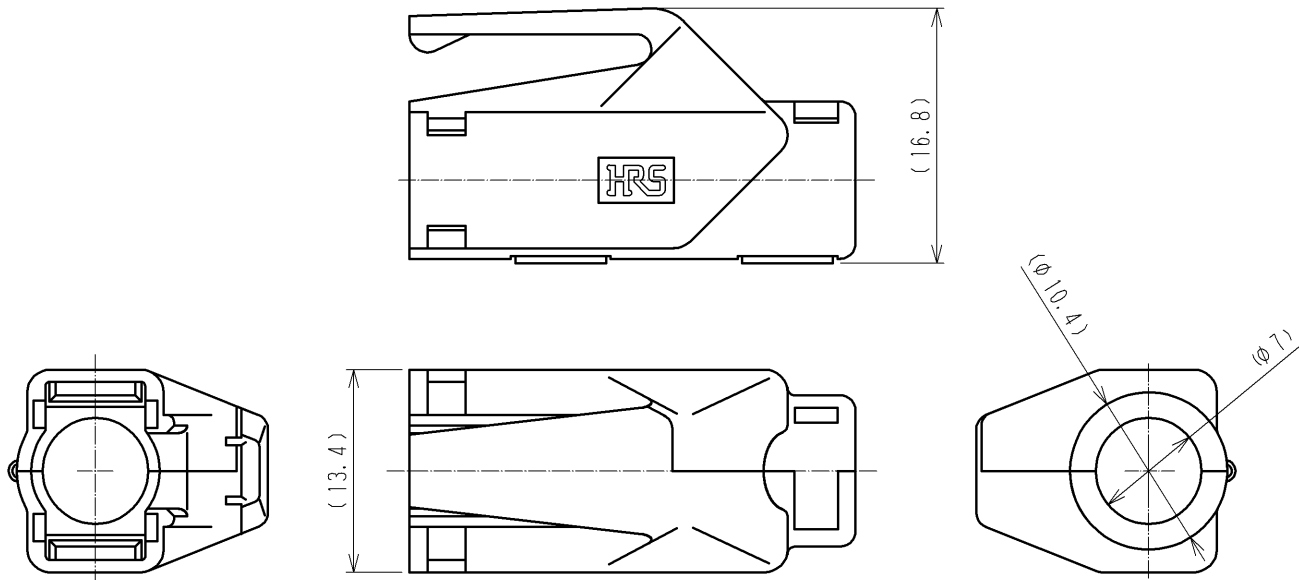

HOOD ATTACHMENT PROCEDURE  
(FREE)

1. FIT THE OPENED HOOD ON THE CABLE  
AND CLOSE. HOOD DIRECTION IS SHOWN  
AS AN EXAMPLE.

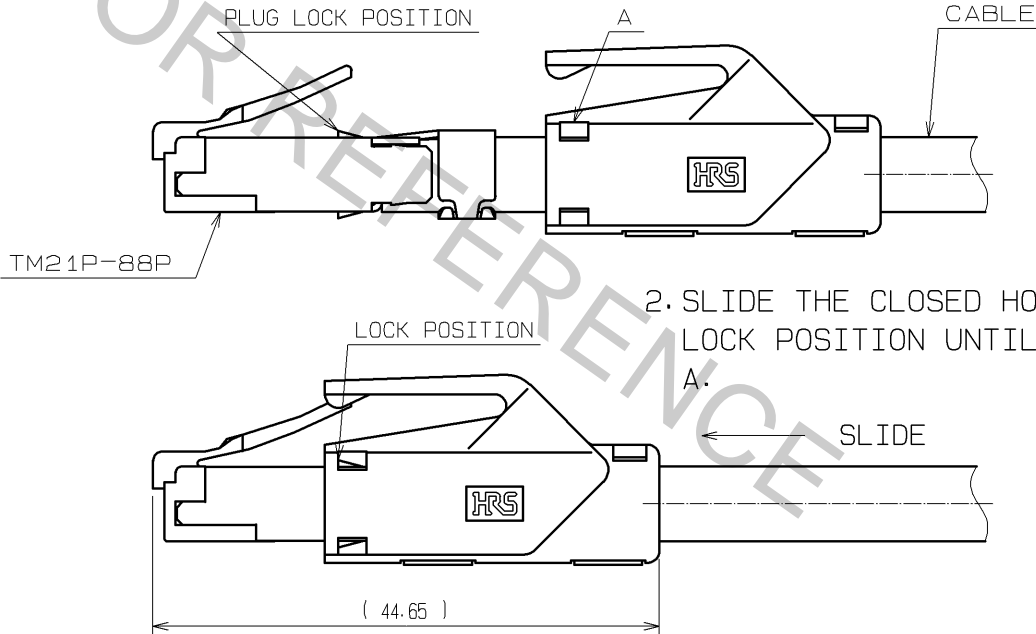

			1			POLYAMIDE			( 2 )			UL94V-2			1			
NO.		MATERIAL		FINISH . REMARKS				NO.		MATERIAL		FINISH . REMARKS						
UNITS mm				SCALE 2 : 1				COUNT 3		DESCRIPTION OF REVISIONS DIS-E-001276			DESIGNED TS. ITO		CHECKED HO. MIWA		DATE 07. 02. 14	
				APPROVED : HO. MIWA				05. 01. 05		DRAWING NO.		EDC3-121484-01						
				CHECED : TH. KAMEYA				05. 01. 05		PART NO.		TM21P-88P ( * * )						
				DESIGNED : SS. SATOH				05. 01. 05		CODE NO.								
				DRAWN : SS. SATOH				05. 01. 05										